

TYPAC
INC.

PO Box 425
Baldwinsville, NY 13027
800 356-8964 315 638-9431
FAX 315 638-9433
www.typac.com
info@typac.com



TYING MACHINE PARTS LIST

MODELS

TM-25
TM-60

TM-36
TM-80

TM-45
TM-100

P.O. BOX 877 • 154 FRONT STREET • BEREA, OHIO 44017 U.S.A. • 216-234-6005
ORDER ENTRY NO. 312-599-5588

DETAILS OF FRAME, MOTOR & TWINE CAN

MODEL 25

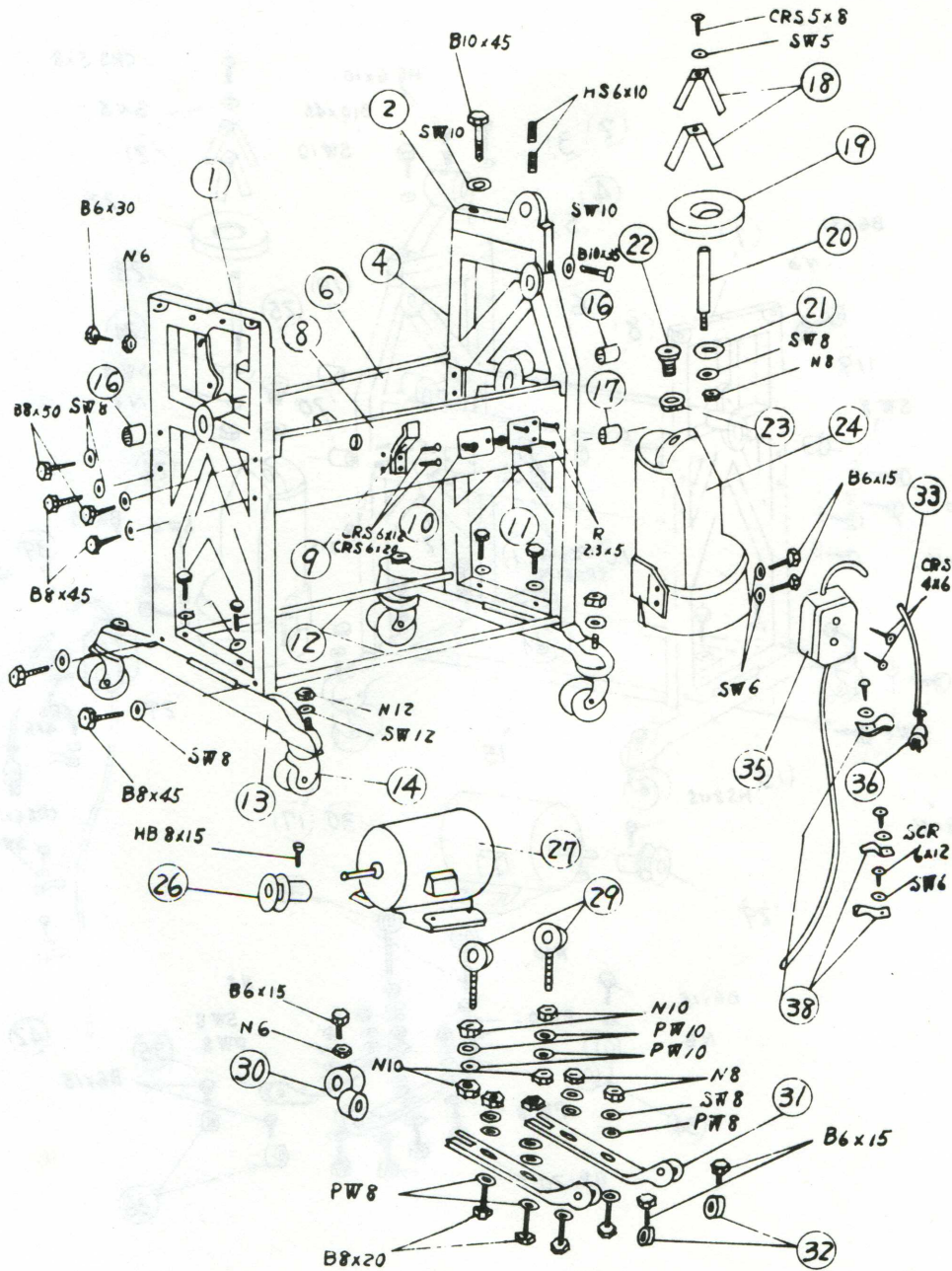

No.	Code No.	Description	Q'ty	No.	Code No.	Description	Q'ty
1	601-4	Front End Frame	1	21	1163-1	Twine Bobbin Shaft Washer	1
2	681K-2	Twine Arm Bearing Base	1	22	696	Twine Guide	1
4	602B-4	Rear End Frame	1	23	697	Twine Guide Nut	1
6	684B-1	Left Side Frame	1	24	623K-3	Twine Can Assy.	1
8	685-6	Right Side Frame	1	26		Motor Pulley	1
9	622C	Hock for Electric Cord	1	27		Motor	1
10	790A	Trade Mark Plate	1	29	830B-1	Motor Adjusting Screw	2
11	790B	String Diagram	1	30	674B	Pedal Joint Bracket	1
12	686R-2	Frame Stay	2	31	1027	Motor Base	2
13	606-1	Foot Base	2	32	10314K	Collar	2
14		Castor	4	33		Electric Cord	1
16		Needle Roller Bearing SC1616Z	2	35		Switch	1
17		Needle Roller Bearing SC1416Z	1	36		Plug	1
18	630	Twine Bobbin Holder Spring	1	38	631-2	Electric Cord Keeper	3
19	1164-3	Bobbin Base	1				
20	1162-3	Twine Bobbin Shaft	1				

DETAILS OF FRAME, MOTOR & TWINE CAN

MODEL 36, 45 & 60

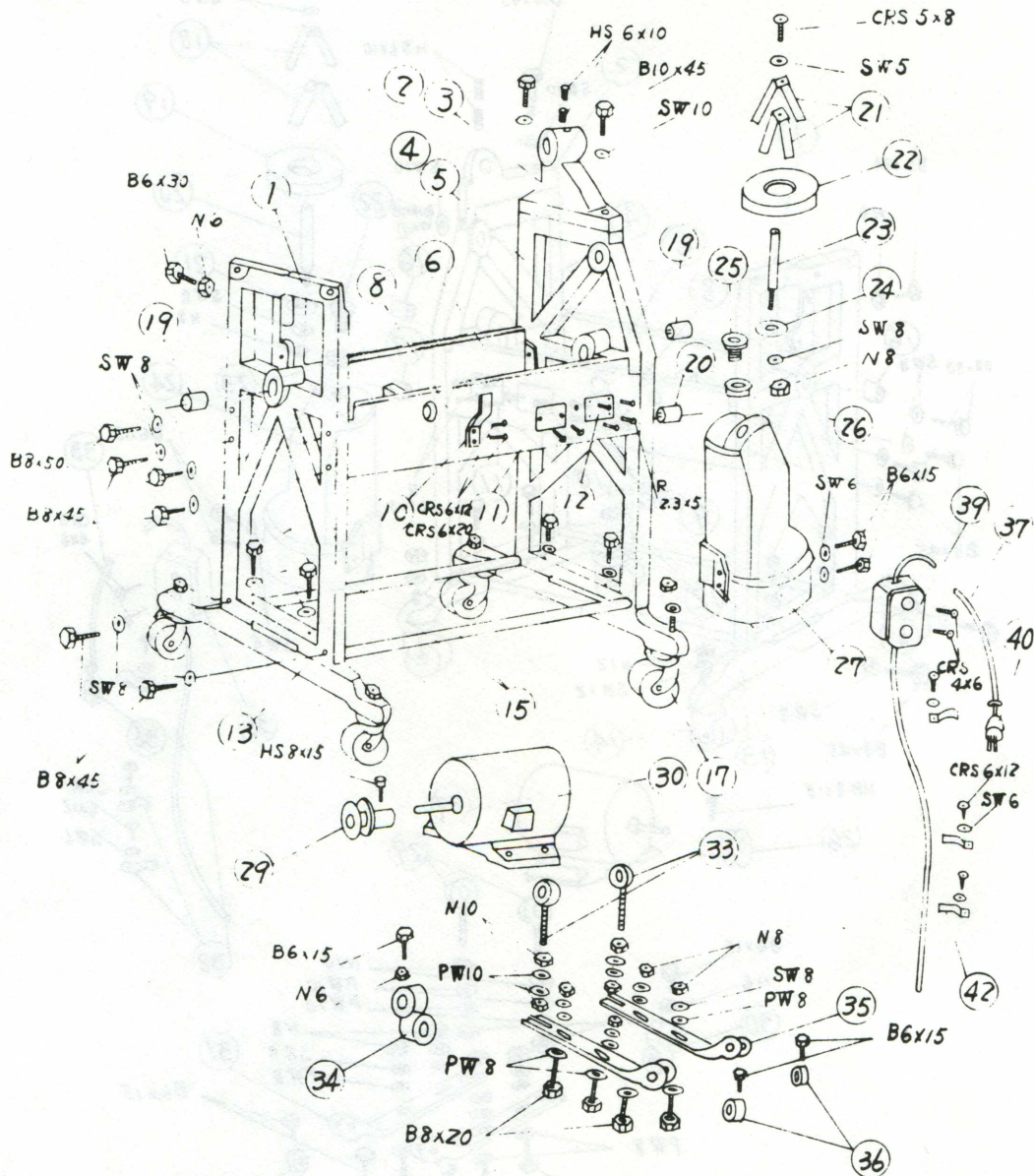

No.	Code No.	Description	Q'ty	No.	Code No.	Description	Q'ty
1	601-4	Front End Frame	1	23	1162-3	Twine Bobbin Shaft	1
2	603K-1	Twine Arm Bearing Base for 45	1	24	1163-1	Twine Bobbin Shaft Washer	1
3	683-1	Twine Arm Bearing Base for 60	1	25	696	Twine Guide	1
4	602-5	Rear End Frame for 45	1	26	697	Twine Guide Nut	1
5	602D-1	Rear End Frame for 60	1	27	623K-3	Twine Can Assy.	1
6	604-3	Left Side Frame	1	29		Motor Pulley	1
8	605-2	Right Side Frame	1	30		Motor	1
10	622C	Hook for Electric Cord	1	33	830B-1	Motor Adjusting Screw	2
11	790A	Trade Mark Plate	1	34	674B	Pedal Joint Bracket	1
12	790B	String Diagram	1	35	1027	Motor Base	2
13	606-1	Foot Base	2	36	10314K	Collar	2
15	607R-3	Frame Stay	2	37		Electric Cord	1
17		Castor	4	39		Switch	1
19		Needle Roller Bearing SC1616Z	2	40		Plug	1
20		Needle Roller Bearing SC1416Z	1	42	631-2	Electric Cord Keeper	3
21	630	Twine Bobbin Holder Spring	2				
22	1164	Bobbin Base	1				

DETAILS OF FRAME, MOTOR & TWINE CAN

MODEL 80 & 100

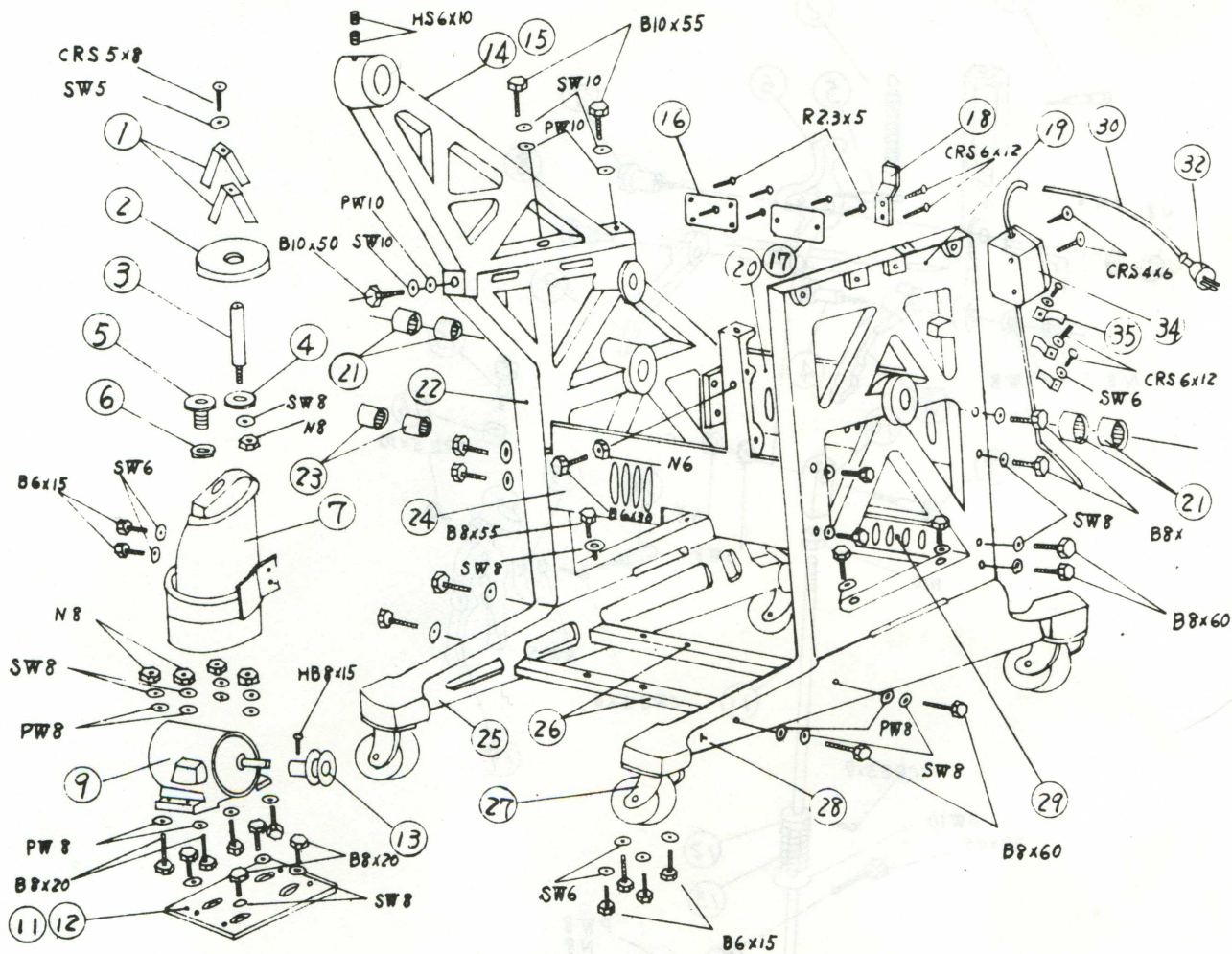

No.	Code No.	Description	Q'ty	No.	Code No.	Description	Q'ty
18	622C	Hook for Electric Cord	1	1	630	Twine Bobbin Holder Spring	2
19	1001-5	Front End Frame	1	2	1164-3	Bobbin Base	1
20	1004-8	Right Side Frame	1	3	1162-3	Twine Bobbin Shaft	1
21		Needle Roller Bearing SC1612	4	4	1163-1	Twine Bobbin Shaft Washer	1
22	1002-6	Rear End Frame	1	5	696	Twine Guide	1
23		Needle Roller Bearing SC1412	2	6	697	Twine Guide Nut	1
24	1005-14	Left Side Frame	1	7	623K-3	Twine Can Assy.	1
25	1003B-3	Foot Base (Rear Side)	2	9		Motor	1
26	1007L	Frame Stay	4	11	1023H	Motor Base for Single Phase	1
27		Castor	1	12	1023F	Motor Base for Three Phase	1
28	1003A-2	Foot Base (Front Side)	1	13		Motor Pulley	1
29	1006	Side Plate	1	14	8501-4	Twine Arm Bearing Base for 80	1
30		Electric Cord	1	15	1008-2	Twine Arm Bearing Base for 100	1
32		Plug	1	16	790A	Trade Mark Plate	1
34		Switch	1	17	790B	String Diagram	1
35	631-2	Electric Cord Keeper	3				

DETAILS OF KICKOUT LEVER

MODEL 25, 36, 45 & 60

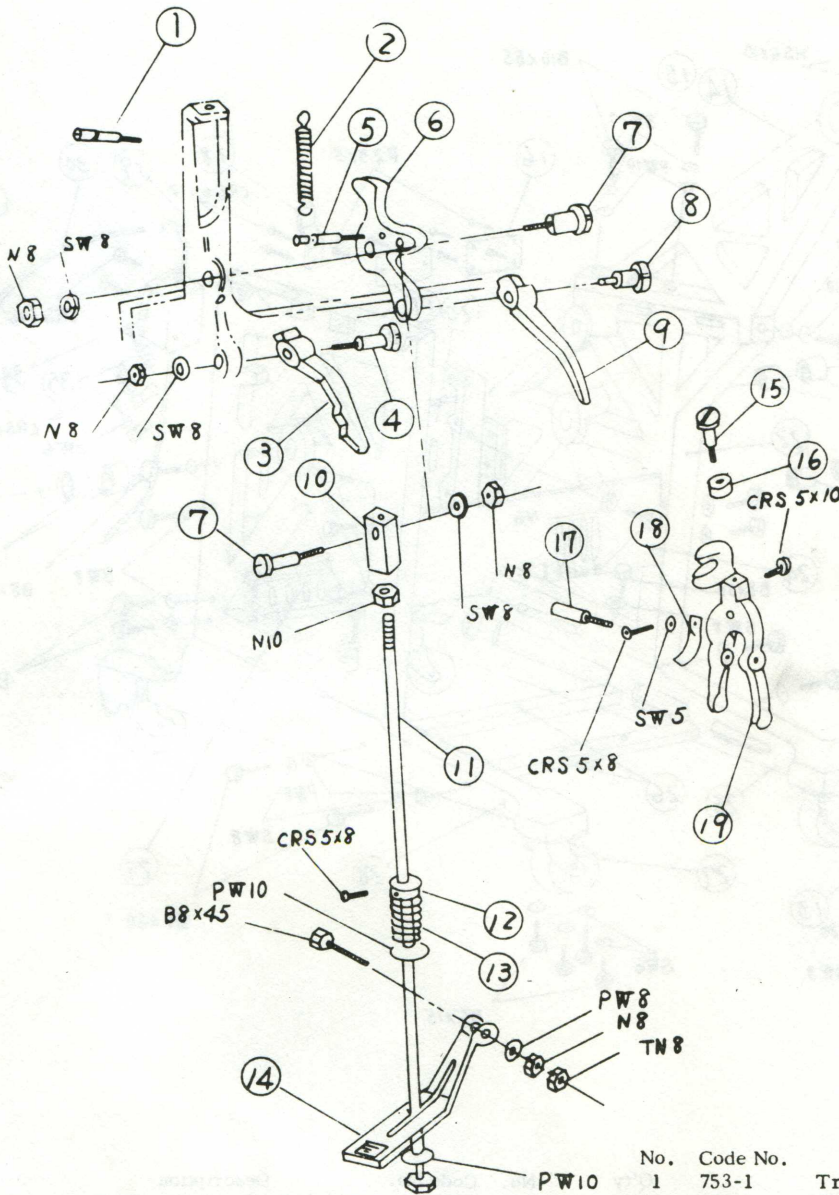

No.	Code No.	Description	Q'ty
1	753-1	Trip Spring Stud	1
2	676-1	Trip Spring	1
3	662-1	Clutch Block Kickout Lever (A)	1
4	634-2	Trip Rod Screw	1
5	667	Spring Stud	1
6	661-1	Trip Bell Crank	1
7	635-3	Pivot Screw	2
8	670-1	Kickout Lever Pin	1
9	663-1	Clutch Block Kickout Lever (B)	1
10	656-2	Clutch Lever Joint	1
11	655-1	Pedal Rod	1
12	7428K-1	Cushion Spring Collar	1
13	7427	Pedal Cushion Spring	1
14	665B-1	Pedal	1
15	669B-1	Clutch Fork Roller Screw	1
16	669A	Clutch Fork Roller	1
17	658	Clutch Fork Pivot Screw	1
18	625	Clutch Fork Spring	1
19	657-1	Clutch Fork	1

DETAILS OF KICKOUT LEVER

MODEL 80 & 100

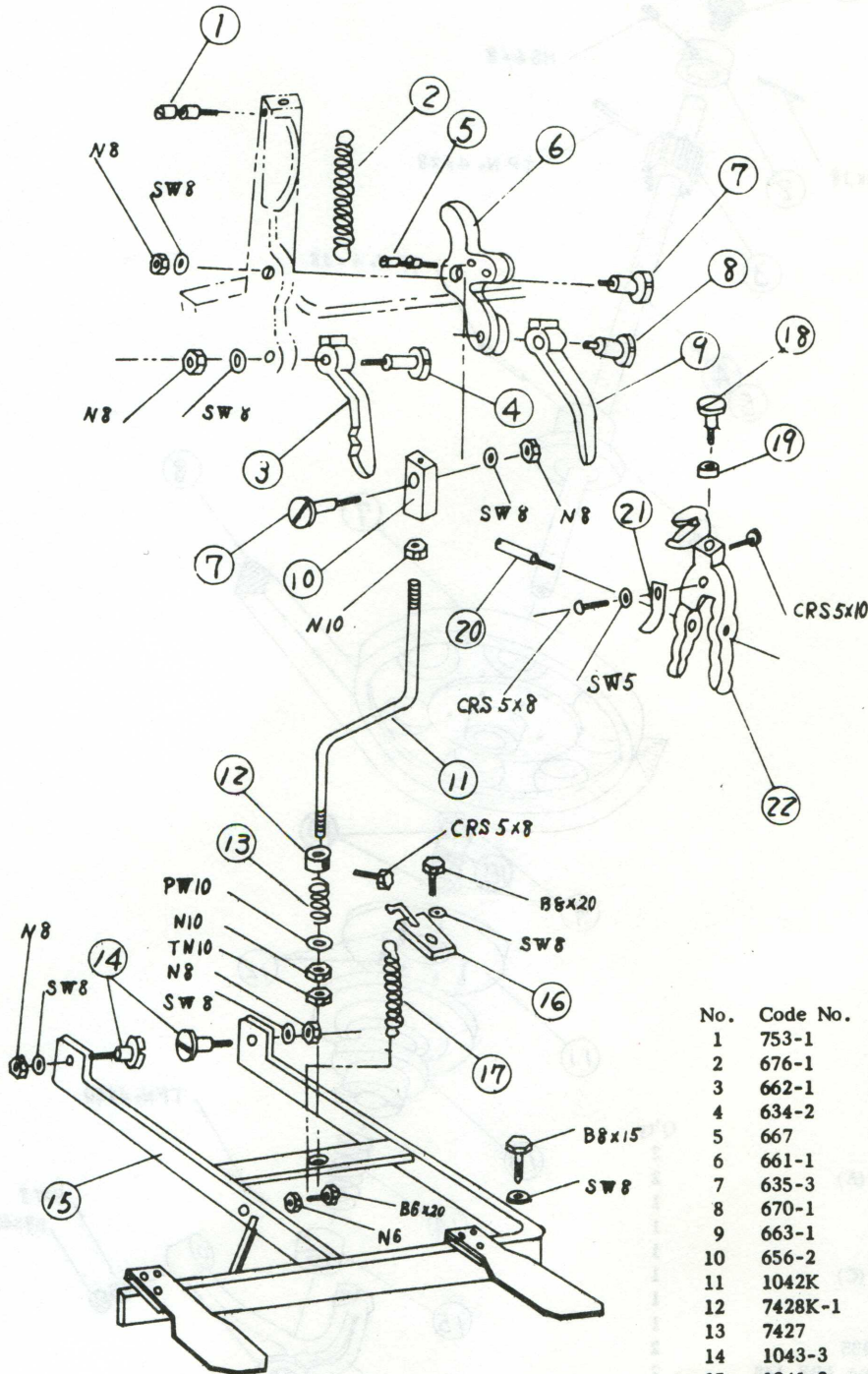

No.	Code No.	Description	Q'ty
1	753-1	Trip Spring Stud	1
2	676-1	Trip Spring	1
3	662-1	Clutch Block Kickout Lever (A)	1
4	634-2	Trip Rod Screw	1
5	667	Spring Stud	1
6	661-1	Trip Bell Crank	1
7	635-3	Trip Bell Crank Pivot Screw	2
8	670-1	Kickout Lever Pin	1
9	663-1	Clutch Block Kickout Lever (B)	1
10	656-2	Clutch Lever Joint	1
11	1042K	Pedal Rod	1
12	7428K-1	Cushion Spring Collar	1
13	7427	Pedal Cushion Spring	1
14	1043-3	Pedal Pivot Screw	2
15	1041-3	Pedal	1
16	1040	Spring Keeper	1
17	692-3	Spring	1
18	669B-1	Clutch Fork Roller Screw	1
19	669A	Clutch Fork Roller	1
20	658	Clutch Fork Pivot Screw	1
21	625	Clutch Fork Spring	1
22	1038-4	Clutch Fork	1

DETAILS OF CLUTCH SHAFT

MODEL 25, 36 & 45

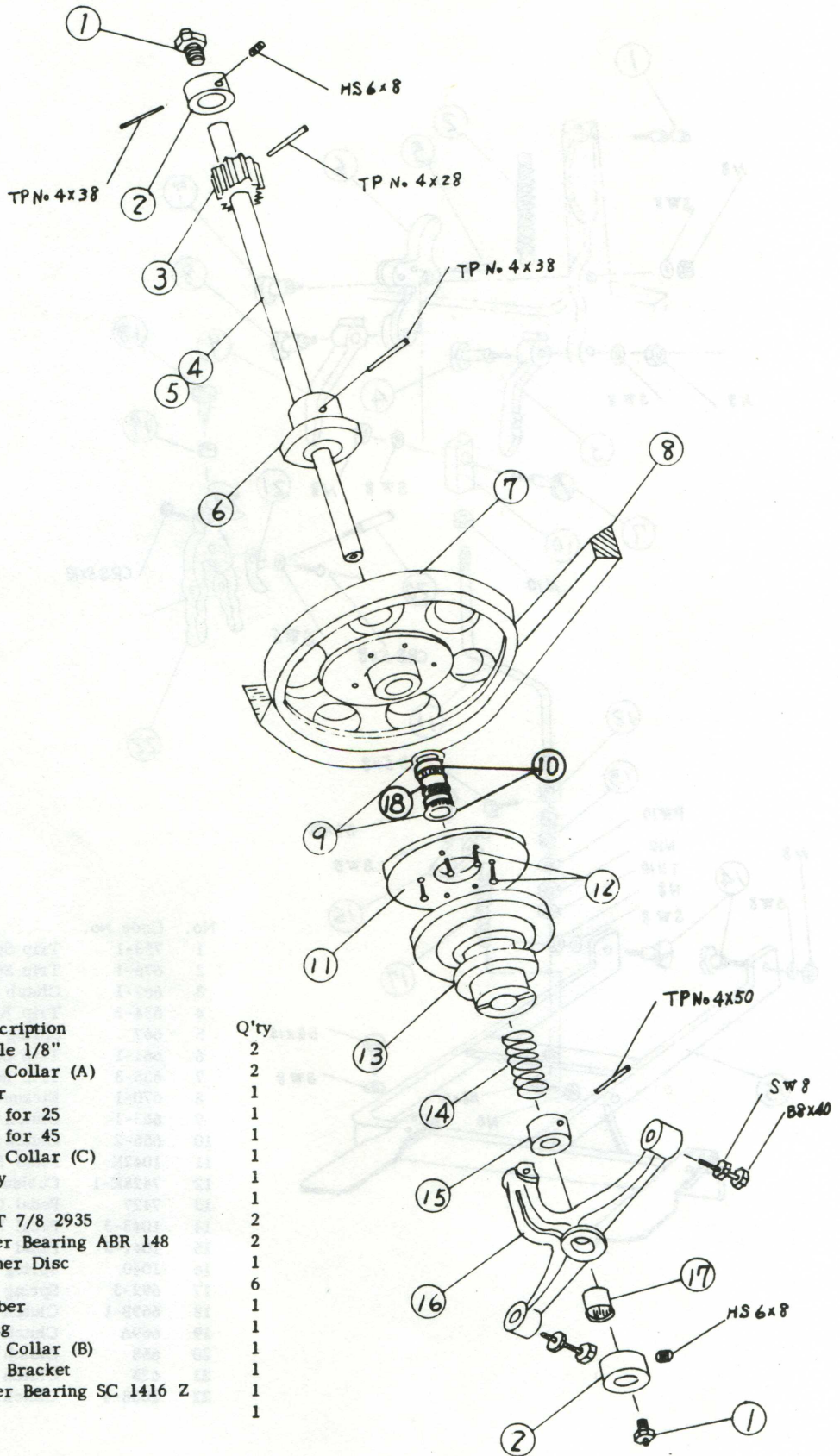

No.	Code No.	Description	Q'ty
1		Grease Nipple 1/8"	2
2	651	Clutch Shaft Collar (A)	2
3	668-1	Driving Gear	1
4	687-4	Clutch Shaft for 25	1
5	650-5	Clutch Shaft for 45	1
6	653	Clutch Shaft Collar (C)	1
7	688-1	Clutch Pulley	1
8		V Belt	1
9		Oil Seal VBT 7/8 2935	2
10		Needle Roller Bearing ABR 148	2
11	672K-1	Clutch Leather Disc	1
12	675-1	Rivet	6
13	660-1	Clutch Member	1
14	671A-2	Clutch Spring	1
15	652-4	Clutch Shaft Collar (B)	1
16	659-4	Clutch Shaft Bracket	1
17		Needle Roller Bearing SC 1416 Z	1
18	699	Collar	1

DETAILS OF CLUTCH SHAFT

MODEL 60, 80 & 100

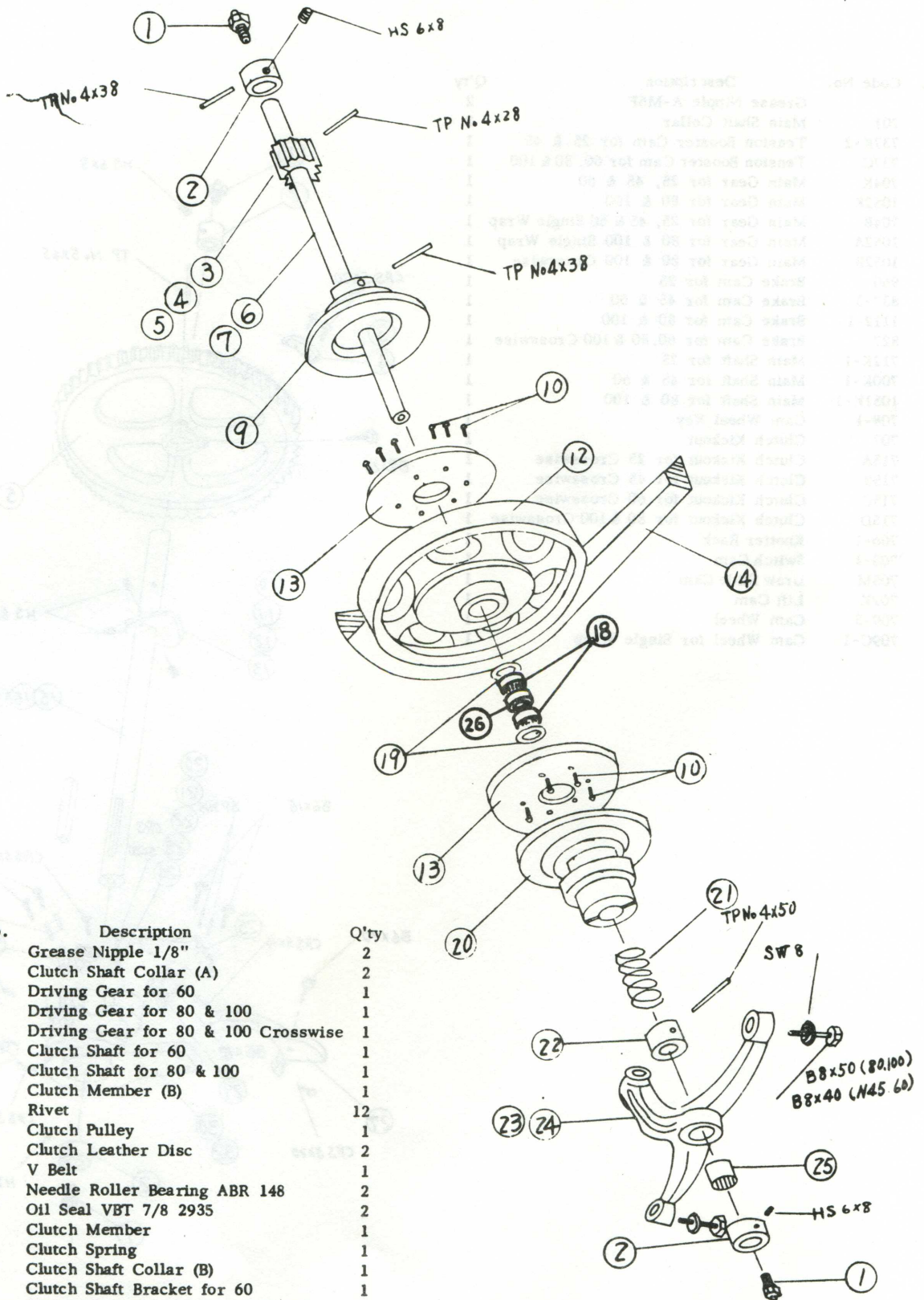

No.	Code No.	Description	Q'ty
1		Grease Nipple 1/8"	2
2	651	Clutch Shaft Collar (A)	2
3	668-1	Driving Gear for 60	1
4	1034	Driving Gear for 80 & 100	1
5	1034A	Driving Gear for 80 & 100 Crosswise	1
6	650-5	Clutch Shaft for 60	1
7	1031-4	Clutch Shaft for 80 & 100	1
9	1035	Clutch Member (B)	1
10	675-1	Rivet	12
12	1032-1	Clutch Pulley	1
13	672K-1	Clutch Leather Disc	2
14		V Belt	1
18		Needle Roller Bearing ABR 148	2
19		Oil Seal VBT 7/8 2935	2
20	660B	Clutch Member	1
21	671B-1	Clutch Spring	1
22	652-4	Clutch Shaft Collar (B)	1
23	659-4	Clutch Shaft Bracket for 60	1
24	1033-4	Clutch Shaft Bracket for 80 & 100	1
25		Needle Roller Bearing SC 1416 Z	1
26	699	Collar	1

DETAILS OF MAIN GEAR

ALL MODELS

No.	Code No.	Description	Q'ty
1		Grease Nipple A-M6F	2
2	701	Main Shaft Collar	2
3	737K-2	Tension Booster Cam for 25 & 45	1
4	737C	Tension Booster Cam for 60, 80 & 100	1
5	704K	Main Gear for 25, 45 & 60	1
6	1052K	Main Gear for 80 & 100	1
7	704B	Main Gear for 25, 45 & 60 Single Wrap	1
8	1052A	Main Gear for 80 & 100 Single Wrap	1
9	1052B	Main Gear for 80 & 100 Crosswise	1
10	960	Brake Cam for 25	1
11	837-3	Brake Cam for 45 & 60	1
12	1112-1	Brake Cam for 80 & 100	1
13	827	Brake Cam for 60, 80 & 100 Crosswise	1
15	712K-1	Main Shaft for 25	1
16	700K-1	Main Shaft for 45 & 60	1
17	1051K-1	Main Shaft for 80 & 100	1
19	708-1	Cam Wheel Key	1
20	707	Clutch Kickout	1
21	715A	Clutch Kickout for 25 Crosswise	1
22	715B	Clutch Kickout for 45 Crosswise	1
23	715C	Clutch Kickout for 60 Crosswise	1
24	715D	Clutch Kickout for 80 & 100 Crosswise	1
25	706-1	Knotter Rack	1
26	703-1	Switch Cam	1
27	705M	Draw Slide Cam	1
29	702K	Lift Cam	1
30	709-3	Cam Wheel	1
32	709C-1	Cam Wheel for Single Wrap	1

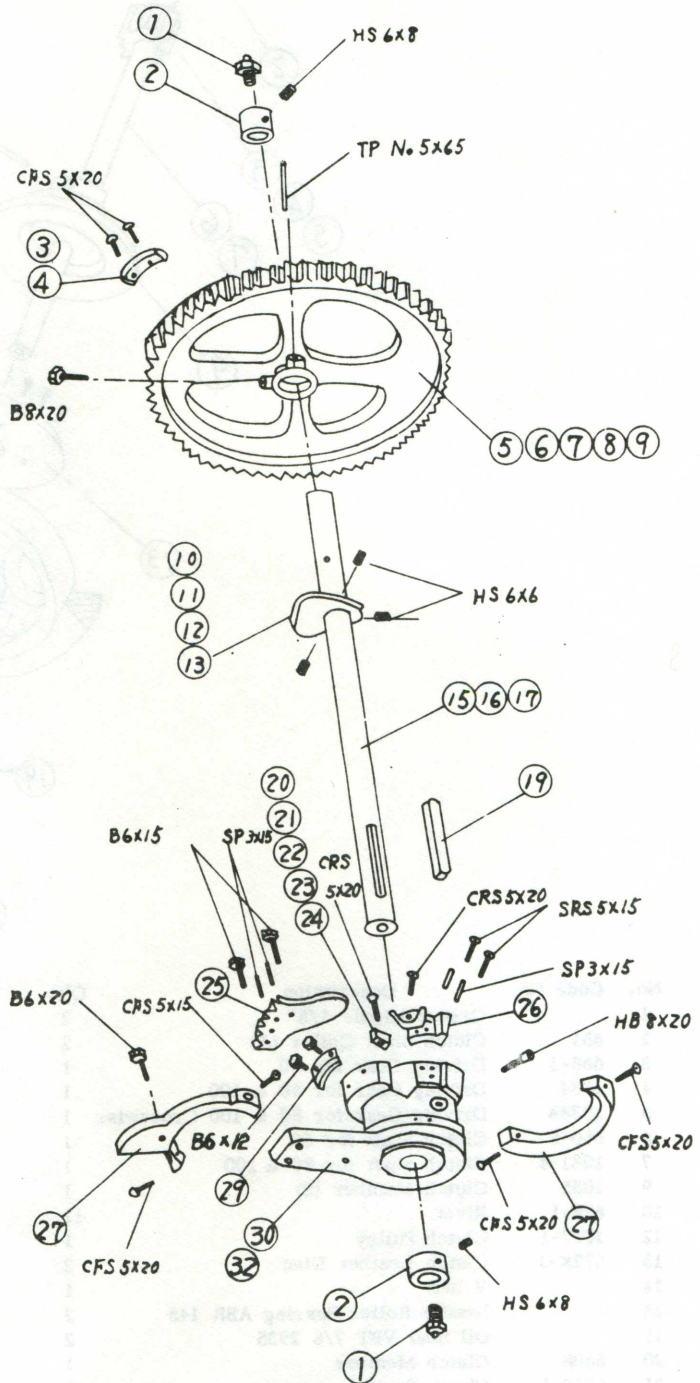

DETAILS OF TENSION BOOSTER

NEW MODEL

No.	Code No.	Description	Q'ty
1	669	Cam Roller Pin	1
2	835	Cam Roller	1
3	1422	Cam Roller Arm (25,36,45,60)	1
4	1435	Cam Roller Arm (80,100)	1
5	1432	Bolt	1
6	1430	Pin	1
7	1423	Twine Tension Spring Base	1
8	1424	Twine Tension Spring	1
9	748	Twine Tension Plate	1
10	1434	Spring (2)	1
11	1431	Shaft	1
12	1429	Lock Spring	1
13	1426	Lock Nut	1
14	1425	Twine Tension Cam	1
15	1433	Spring (1)	1
16	1421	Twine Tension Box	1
17	728	Twine Guide	1
18	1428	Dial Axle Bolt	1
19	1427	Dial	1
20	1436	Index Plat	1

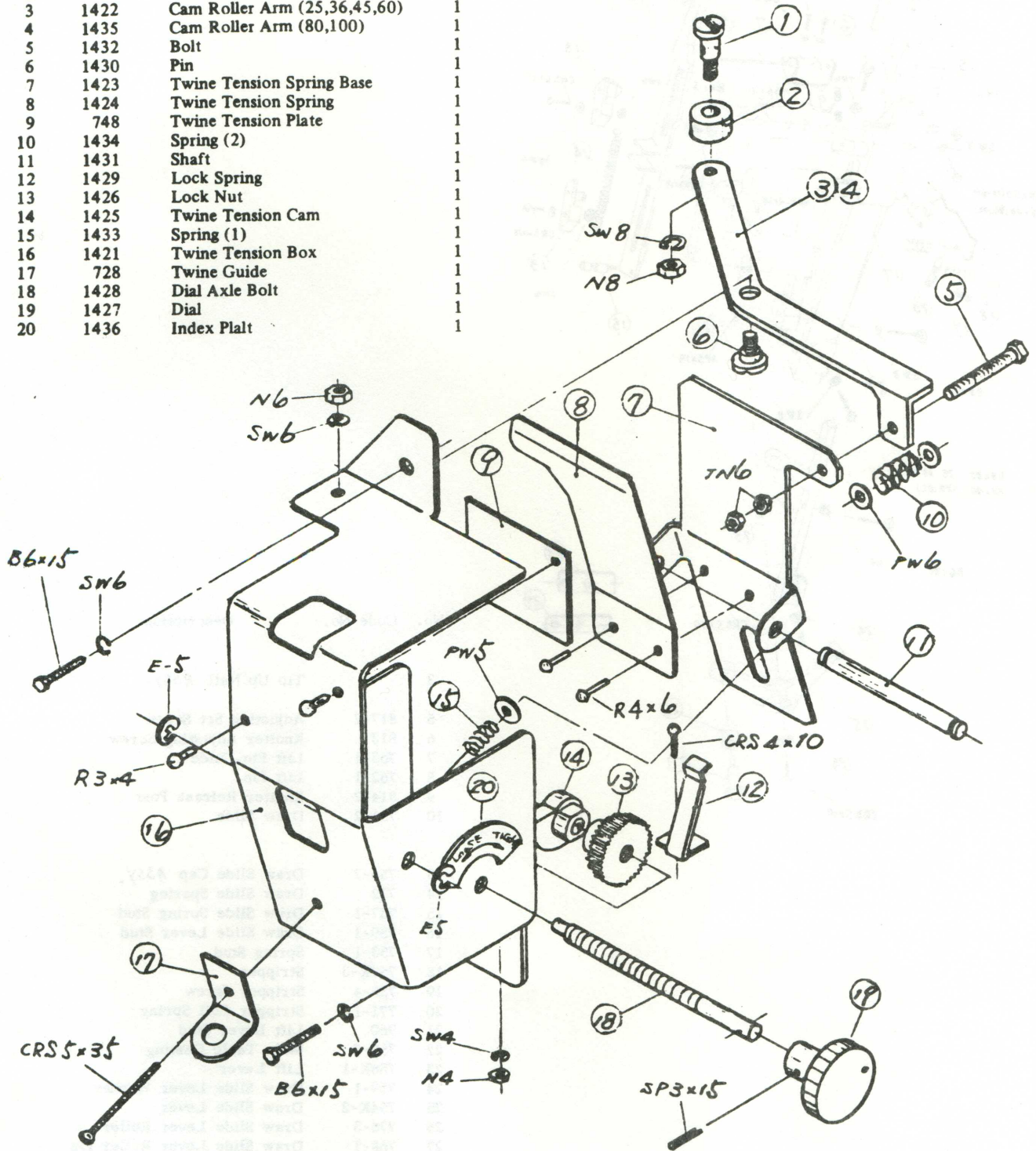

DETAILS OF MAIN TABLE CASTING

ALL MODELS

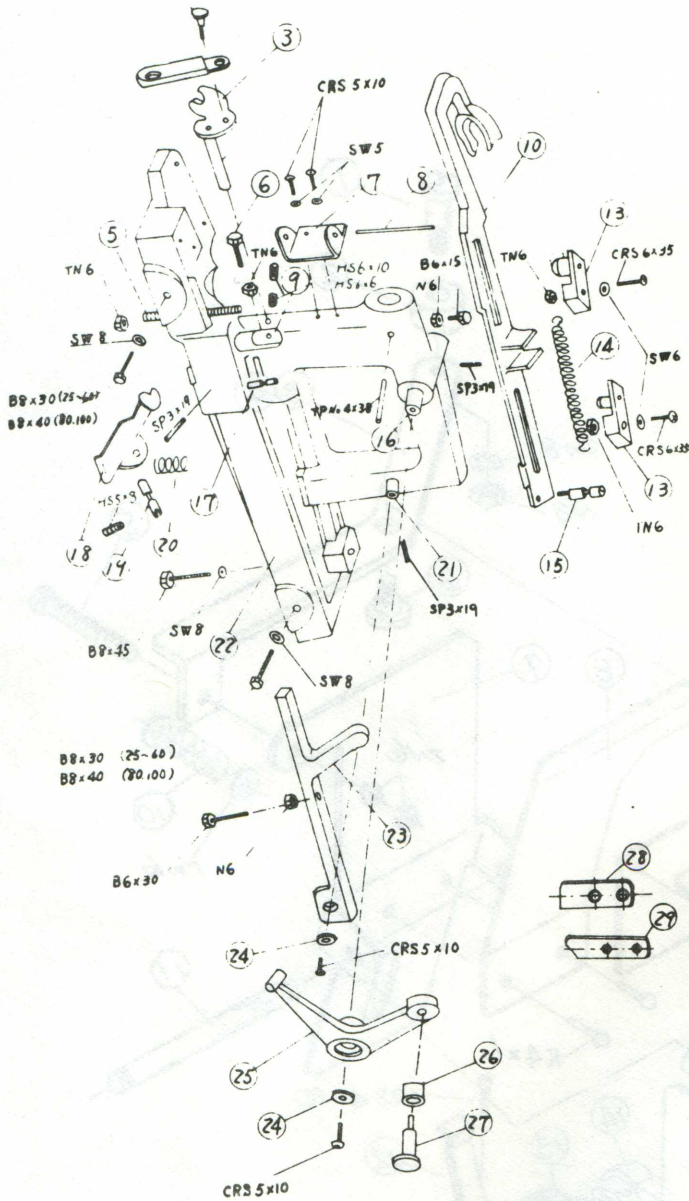

No.	Code No.	Description	Qty
3		Tip Up Nail Assy.	1
5	817-2	Adjusting Set Screw	1
6	813	Knotter Adjusting Screw	1
7	763-1	Lift Pin Guide	1
8	762-1	Lift Pin	1
9	814-2	Knotter Release Post	1
10	751-2	Draw Slide	1
13	756-2	Draw Slide Cap Assy.	2
14	772	Draw Slide Sparing	1
15	767-1	Draw Slide Spring Stud	1
16	759-1	Draw Slide Lever Stud	1
17	753-1	Spring Stud	1
18	757K-3	Stripper	1
19	755-4	Stripper Screw	1
20	771-1	Stripper Coil Spring	1
21	760	Lift Lever Stud	1
22	750-7	Main Table Casting	1
23	758K-1	Lift Lever	1
24	769-1	Draw Slide Lever Washer	2
25	754K-2	Draw Slide Lever	1
26	776-3	Draw Slide Lever Roller	1
27	768-1	Draw Slide Lever Roller Pin	1
28	713-3	Plate for 25, 45 & 60 Crosswise	1
29	714-2	Plate for 80 & 100 Crosswise	1

DETAILS OF KNOTTER HEAD

ALL MODELS

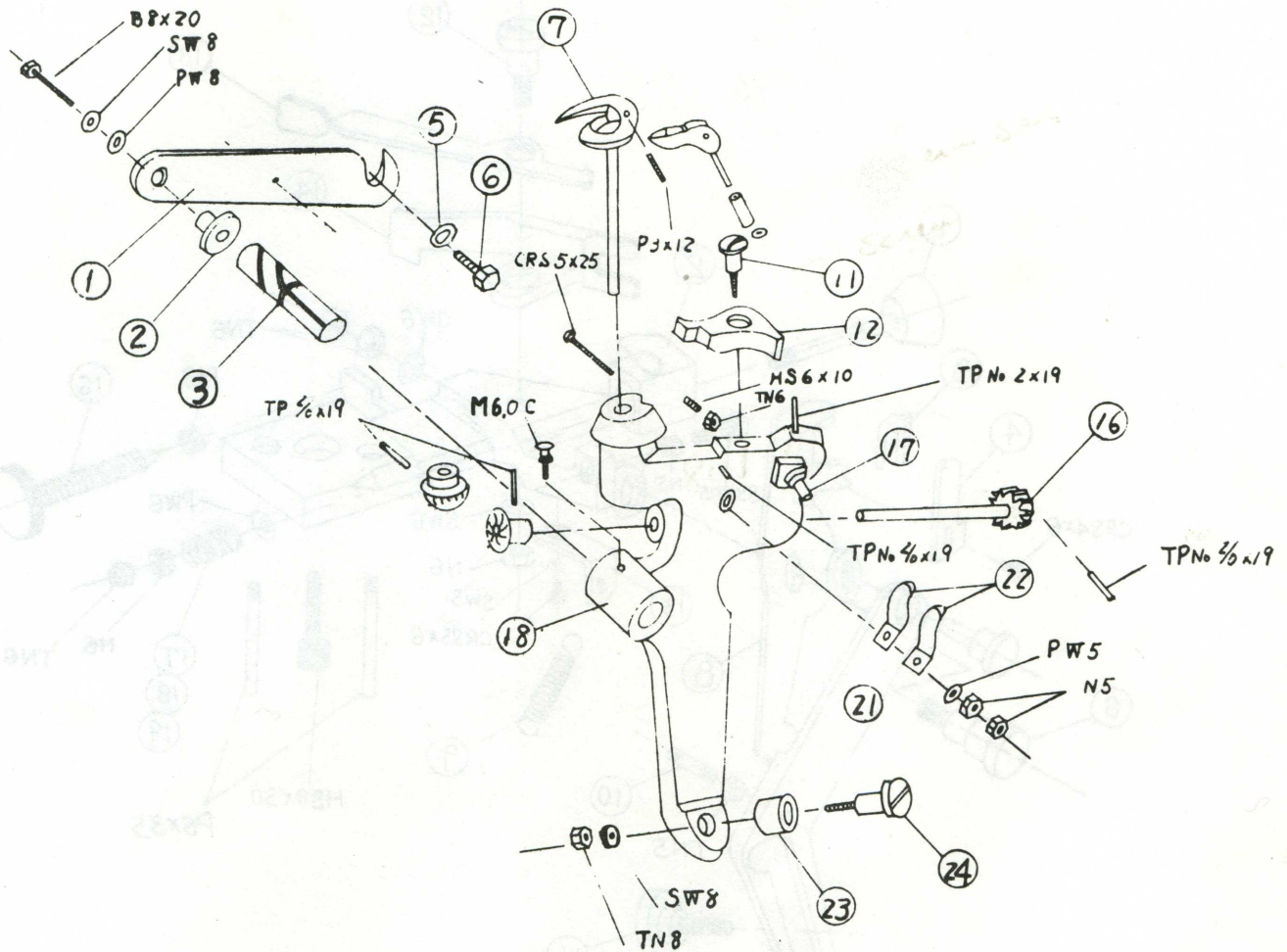

No.	Code No.	Description	Q'ty
1	816-3	Knotter Head Supporter	1
2	849	Knotter Head Pivot Washer	1
3	809L	Knotter Head Pivot	1
5	821-1	Washer for Supporter Bolt	1
6	820-1	Supporter Bolt	1
7	KH-AM	Knotter	1
11	815K-3	Knotter Lever Screw	1
12	801-1	Knotter Lever	1
16		Pinion (Star Wheel) ASSY.	1
17	808K	Tip Up Lever Stud	1
18	800-4	Knotter Head	1
21	824	Knotter Type Number Plate	1
22	812K	Knotter Flat Spring	2
23	776-3	Knotter Head Roller	1
24	807K-1	Knotter Head Roller Pin	1

(KH-AM) Knotter
 KHAM Knotter Head Ass'y.
 (Includes 7, 8, 9, 10 & 13, TP 2/0 x 19)

DETAILS OF STRINGHOLDER

ALL MODELS

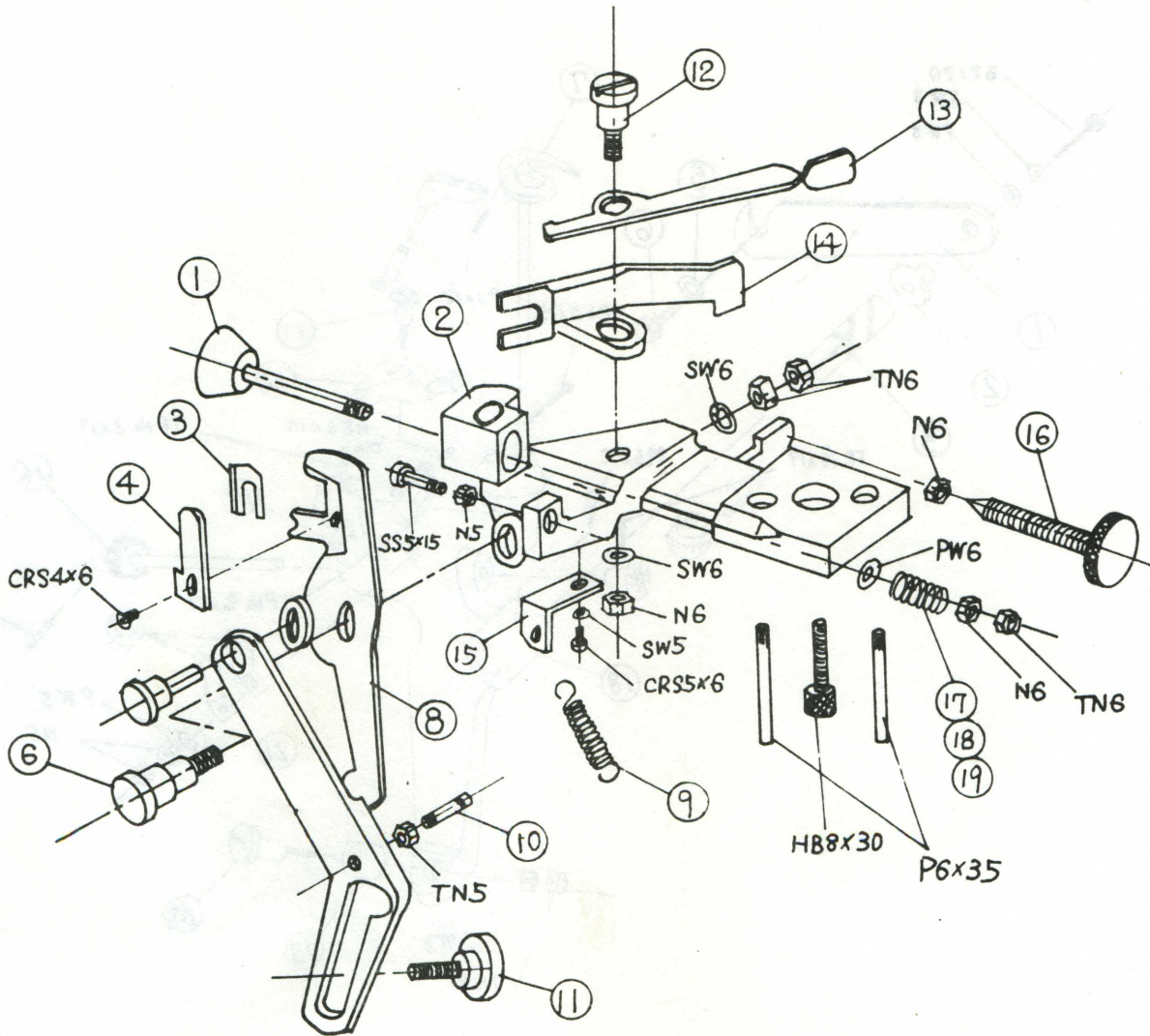

No.	Code No.	Description	Q'ty
1	851-3	Stringholder Button	1
2	850E-3	Stringholder	1
3	859K-3	Knife	1
4	854B-1	Knife Holder	1
6	860-4	Knife Pivot Screw	1
8	2011-A	Knife Trap Assy.	1
9	862	Knife Trap Spring	1
10	857K	Knife Trap Spring Stud	1
11	811-3	Knife Trap Guide Pin	1
12	869-1	Stringholder Release Lever Pivot Screw	1
13	856-1	Stringholder Button Release Lever	1
14	868	Stringholder Button Adjusting Screw	1
15	858K	Spring Stud	1
16	870-1	Stringholder Adjusting Screw	1
17	855A-2	Stringholder Button Spring (1.4m/m)	1
18	855B-2	Stringholder Button Spring (1.6m/m)	1
19	855C	Stringholder Button Spring (1.8m/m)	1
850-D		Stringholder Ass'y. (Includes 1-19)	
2011-A		Knife Ass'y. (Includes 3, 4, CRS 4x6, 5, 7, 8, 10 & TN-5)	

DETAILS OF SAFETY DEVICE

MODEL 25, 36, 45 & 60

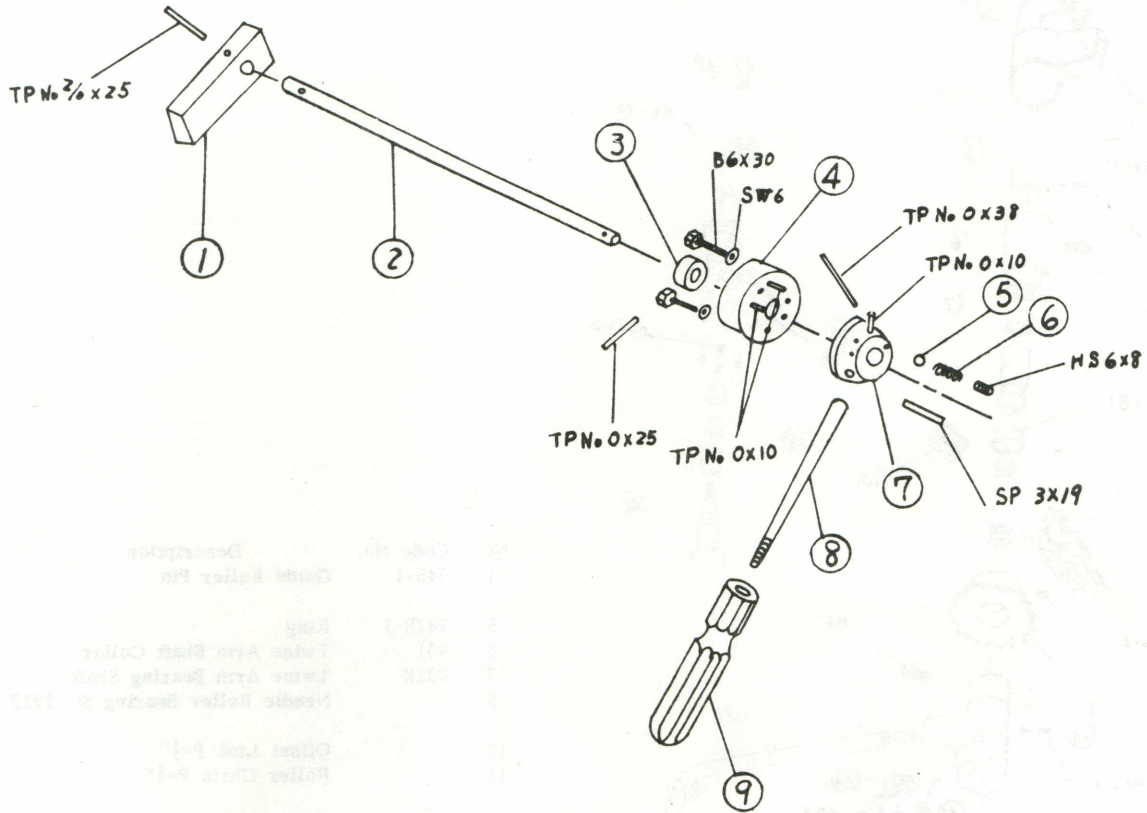

(Faint mirrored text from the reverse side of the page)

No.	Code No.	Description	Q'ty
1	881-1	Stopper Plate	1
2	880-1	Shaft	1
3	879	Collar	1
4	877K	Safety Device Part	1
5	882	Steel Ball 6m/m	1
6	883-1	Spring	1
7	876A	Safety Device Part	1
8	876B	Lever	1
9	875	Grip	1

DETAILS OF TWINE ARM

MODEL 36, 45 & 60

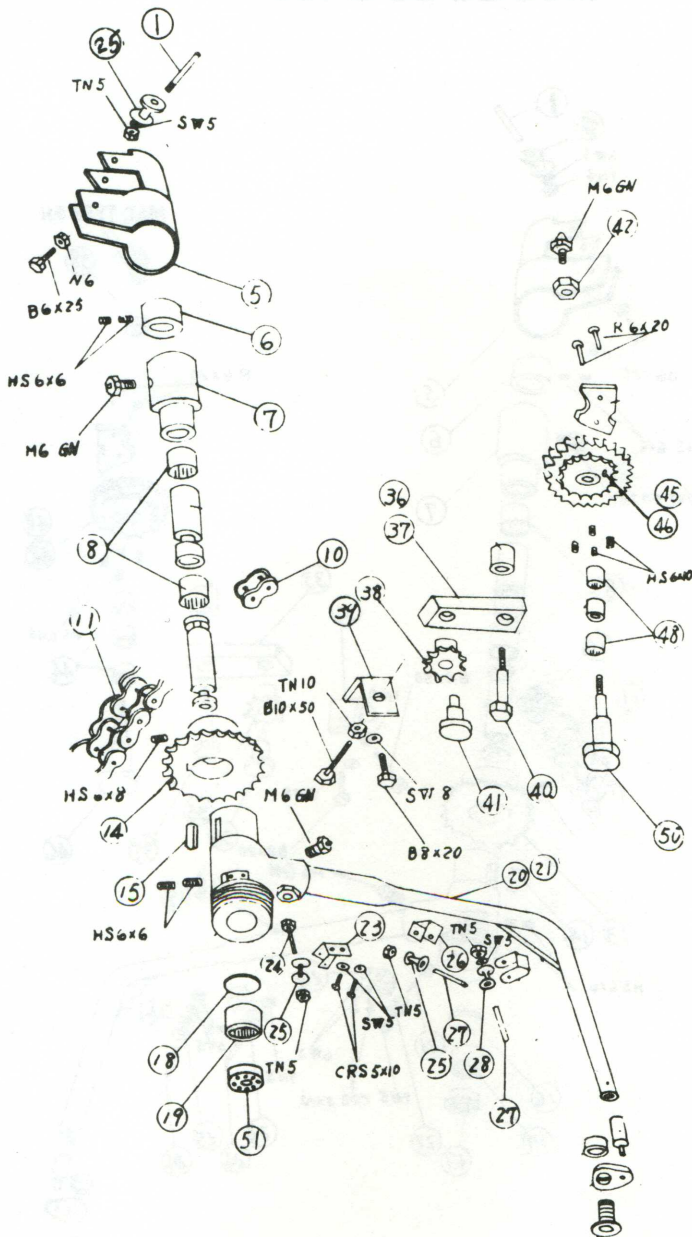

No.	Code No.	Description	Q'ty
1	745-1	Guide Roller Pin	1
5	741B-1	Ring	1
6	905	Twine Arm Shaft Collar	1
7	902-1	Twine Arm Bearing Shaft	1
8		Needle Roller Bearing CFC1616Z	2
10		Offset Link P=1/2"	1
11		Roller Chain P=1/2"	1
14	904	Twine Arm Sprocket	1
15	919	Twine Arm Key	1
18	941	Bearing Base Plate	1
19		Needle Roller Bearing ABR128	1
20		Twine Arm for 45	1
21		Twine Arm for 60	1
23	125K	Twine Guide Roller Bracket	1
24	1257B-1	Twine Guide Roller Pin	1
25	1256B-5	Twine Guide Roller	2
26	1263K	Twine Guide Roller Bracket	1
27	1380-1	Roller Pin	2
28	1256-4	Twine Guide Roller	1
36	695-3	Tension Sprocket Base for 45	1
37	1012-1	Tension Sprocket Base for 60	1
38	689-2	Tension Sprocket	1
39	693K-1	Tension Adjust Supporter	1
40	694	Tension Sprocket Base Pivot Screw	1
41	690-1	Tension Sprocket Pin	1
42	626	Nut	1
45		CHAIN GEAR ASSY. for Single & Double Wrap	1
46		CHAIN GEAR ASSY. for Triple Wrap	1
48		Needle Roller Bearing MHK2520	2
50	646C-3	Gear Shaft	1
51		Ball Bearing 6004	1

DETAILS OF TWINE ARM

MODEL 80 & 100

No.	Code No.	Description	Q'ty
1	745-1	Guide Roller Pin	1
5	741B-1	Ring	1
6	905	Twine Arm Shaft Collar	1
7	1009-1	Twine Arm Bearing Shaft	1
8		Needle Roller Bearing CFC1616Z	2
10		Offset Link P=5/8"	1
11		Roller Chain P=5/8"	1
13	1077	Twine Arm Sprocket	1
14	919	Twine Arm Key	1
16	941	Bearing Base Plate	1
17		Needle Roller Bearing ABR128	1
18	*1071N	Twine Arm for 100	1
19	*8502N	Twine Arm for 80	1
20	1254K	Twine Guide Roller Bracket	1
21	1257B-1	Roller Pin	1
22	1256B-5	Twine Guide Roller	2
24	1380-1	Roller Pin	2
25	1256-4	Twine Guide Roller	1
33	1012-1	Tension Sprocket Base	1
34	1017	Tension Adjust Supporter	1
35	1010-1	Tension Sprocket	1
36	690-1	Tension Sprocket Pin	1
37	694	Tension Sprocket Base Pivot Screw	1
38	626	Nut	1
41	CHAIN GEAR ASSY. for Single & Double Wrap		1
42	CHAIN GEAR ASSY. for Triple Wrap		1
44	Needle Roller Bearing MHK2520		2
46	1018D-3	Gear Shaft	1
47		Ball Bearing 6004	1

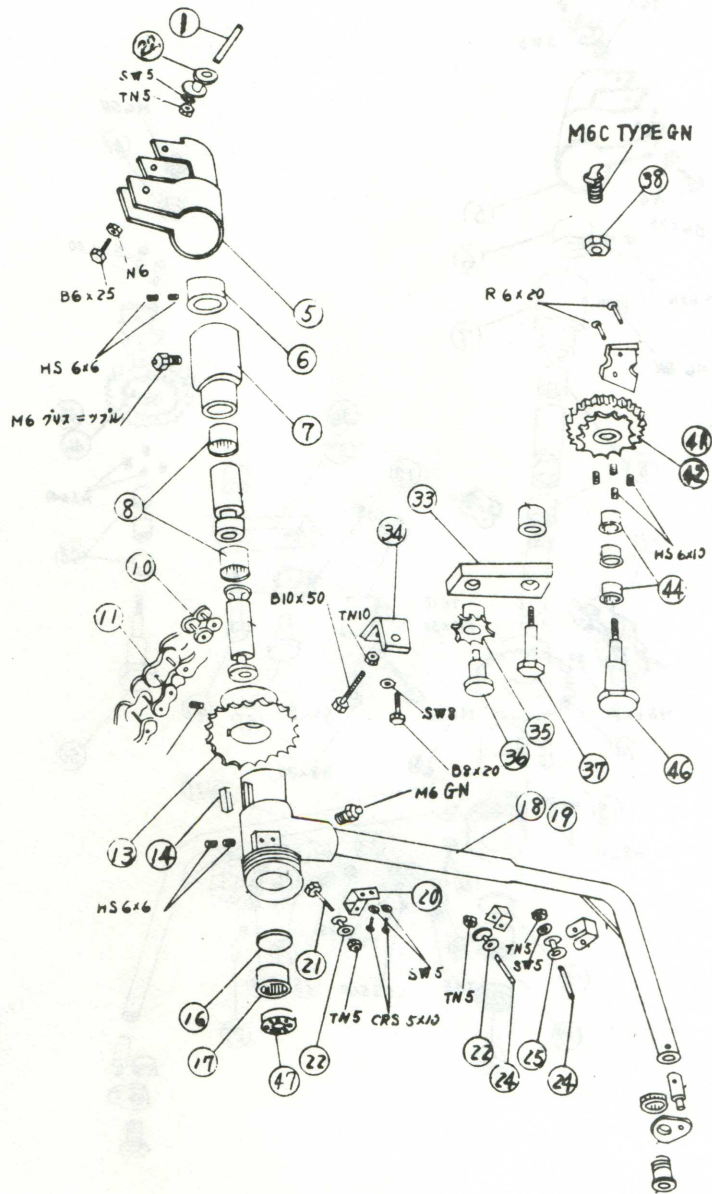

DETAILS OF TWINE DRAW UP LEVER

MODEL 25, 36 & 45

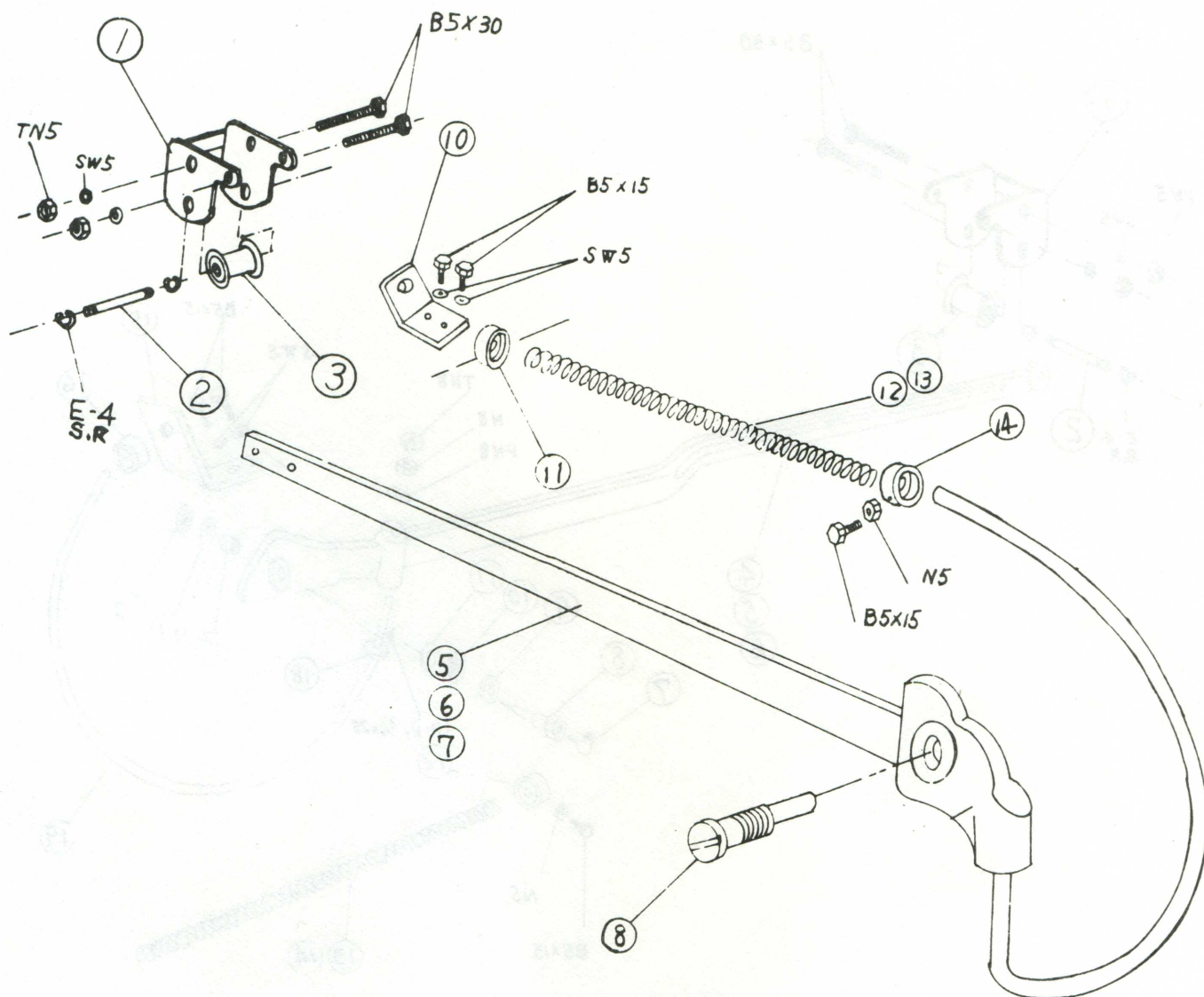

No.	Code No.	Description	Q'ty
1	1015	Twine Guide Bracket	1
2	1016	Twine Guide Roller Pin	1
3	1256-4	Twine Guide Roller	1
5	922L-2	Twine Draw Up Lever for 25	1
7	918-5	Twine Draw Up Lever for 45	1
8	916D-2	Twine Draw Up Lever Pin	1
10	917K	Cushion Spring Guide Head	1
11	845B-2	Collar	1
12	920A-1	Cushion Spring for 25	1
13	920-1	Cushion Spring for 45	1
14	843L	Collar	1

DETAILS OF TWINE DRAW UP LEVER

MODEL 60, 80 & 100

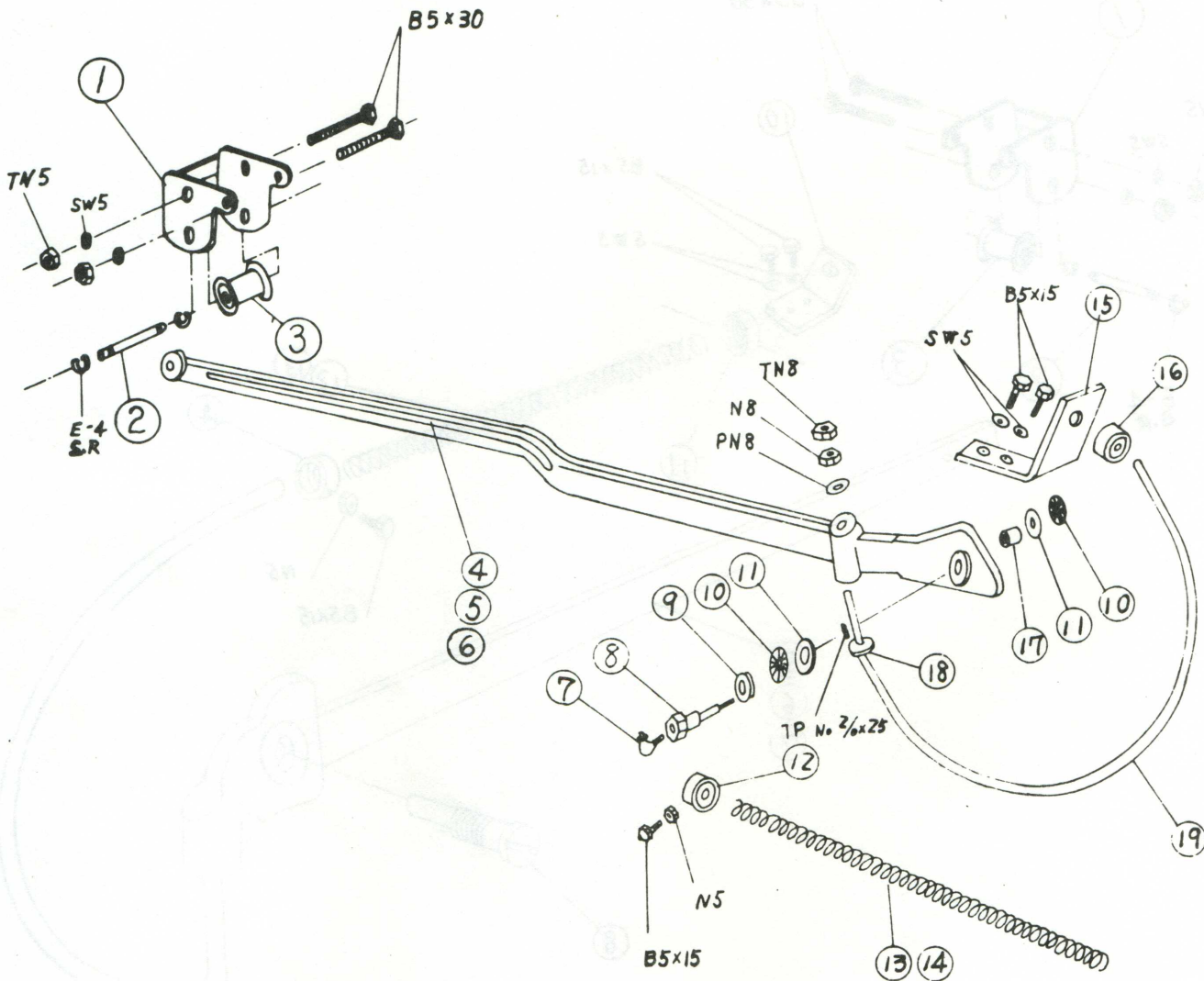

No.	Code No.	Description	Q'ty
1	1015	Twine Guide Bracket	1
2	1016	Twine Guide Roller Pin	1
3	1256-4	Twine Guide Roller	1
4	923K-1	Twine Draw Up Lever for 60	1
5	8541-1	Twine Draw Up Lever for 80	1
6	1078L-2	Twine Draw Up Lever for 100	1
7		Grease Nipple 6M	1
8	916L	Twine Draw Up Lever Pin	1
9	1068	Bearing Cover	1
10		Thrust Needle Bearing AX1326	2
11		Thrust Bearing Race PL1326	2
12	843L	Collar	1
13	920E-1	Cushion Spring for 60	1
14	1107K-3	Cushion Spring for 80 & 100	1
15	917C-1	Cushion Spring Guide Head	1
16	845B-2	Collar	1
17		Needle Roller Bearing TLA1210	1
18	1067B	Spring Guide Collar	1
19	948L-2	Cushion Spring Guide	1

DETAILS OF BRAKE

MODEL 25

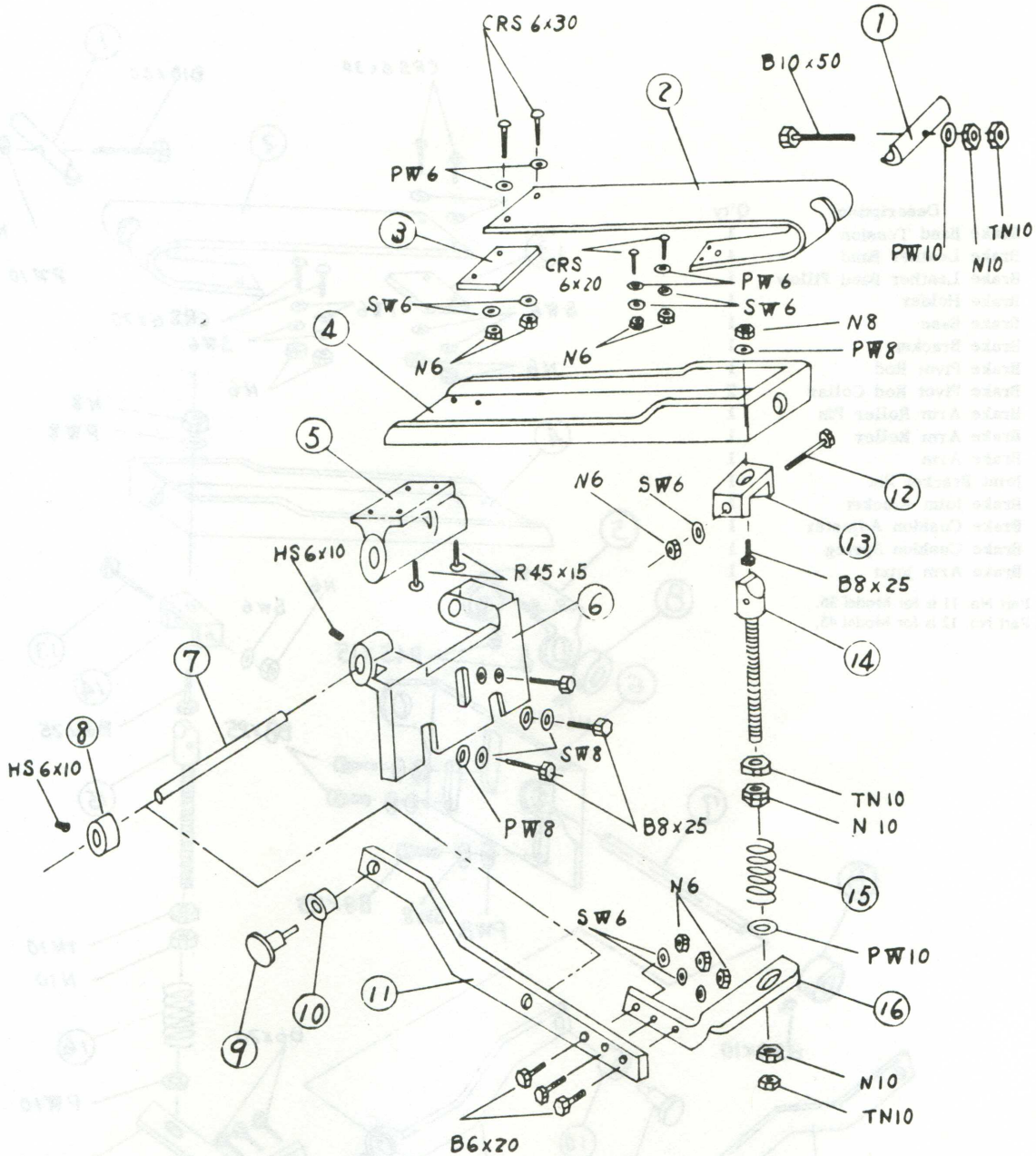

No.	Code No.	Description	Q'ty
1	832K	Brake Band Tension	1
2	828-2	Brake Leather Band	1
3	828B-2	Brake Leather Band Pillow	1
4	953	Brake Holder	1
5	951-1	Brake Base	1
6	950K-1	Brake Bracket	1
7	826-1	Brake Pivot Rod	1
8	825-1	Brake Pivot Rod Collar	1
9	836-1	Brake Arm Roller Pin	1
10	835-1	Brake Arm Roller	1
11	962K	Brake Arm	1
12	964	Joint Bracket Pin	1
13	956	Brake Joint Bracket	1
14	831-3	Brake Cushion Adjuster	1
15	924-2	Brake Cushion Spring	1
16	961-5	Brake Arm Joint	1

DETAILS OF BRAKE

MODEL 36 & 45

No.	Code No.	Description	Q'ty
1	832K	Brake Band Tension	1
2	828-2	Brake Leather Band	1
3	828B-2	Brake Leather Band Pillow	1
4	953	Brake Holder	1
5	951-2	Brake Base	1
6	834-1	Brake Bracket	1
7	826-2	Brake Pivot Rod	1
8	825-1	Brake Pivot Rod Collar	2
9	836-1	Brake Arm Roller Pin	1
10	835-1	Brake Arm Roller	1
12	952-3	Brake Arm	1
13	964	Joint Bracket Pin	1
14	956	Brake Joint Bracket	1
15	831-3	Brake Cushion Adjuster	1
16	924-2	Brake Cushion Spring	1
17	961-5	Brake Arm Joint	1

Brake Arm Part No. 11 is for Model 36.
Brake Arm Part No. 12 is for Model 45.

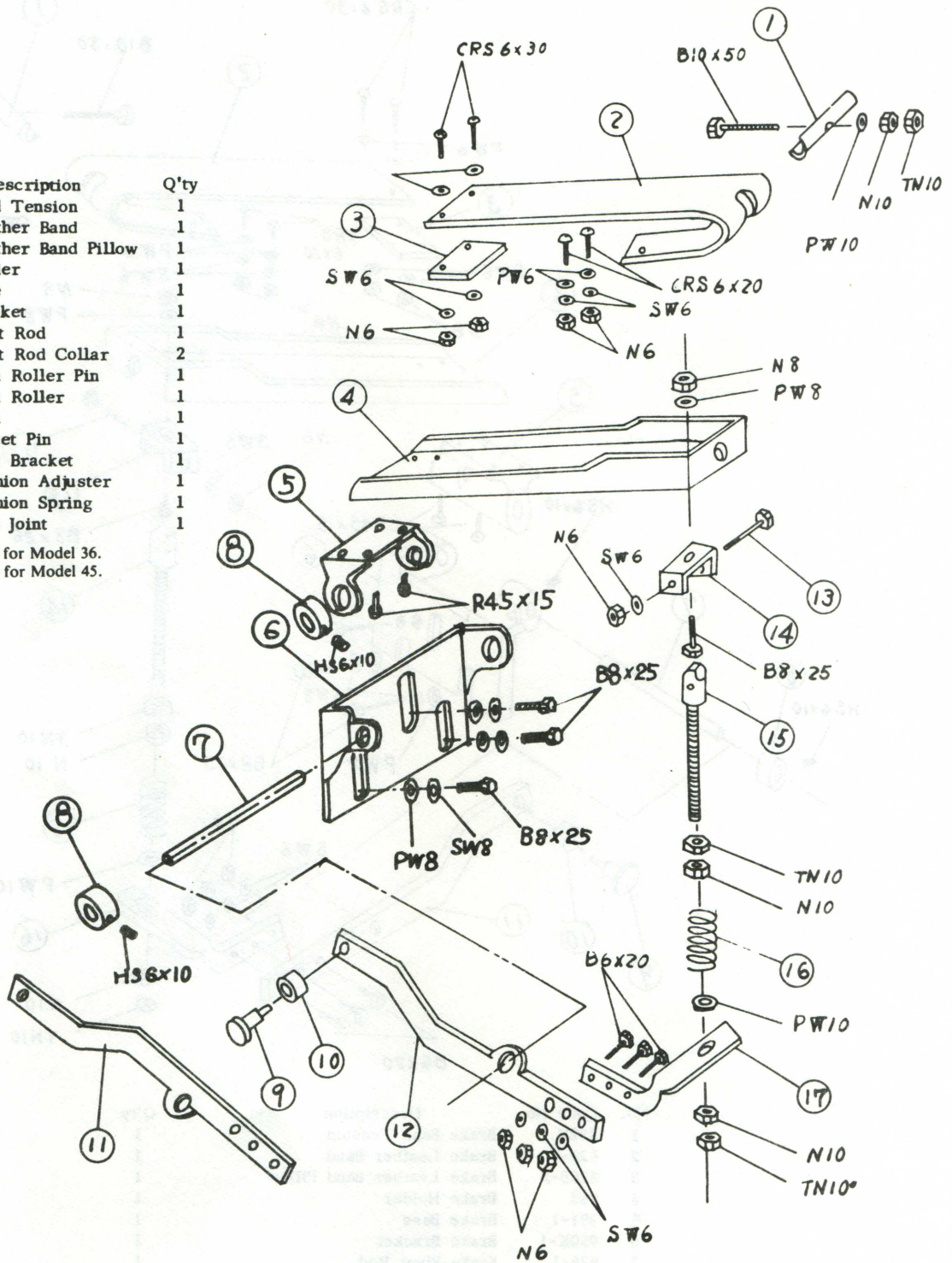

DETAILS OF BRAKE

MODEL 60

No.	Code No.	Description	Q'ty
1	832K	Brake Band Tension	1
2	1118-3	Brake Leather Band A	1
3	1119-2	Brake Leather Band B	1
4	1117K	Brake Holder	1
5	951-2	Brake Base	1
6	833-3	Brake Bracket	1
7	840-3	Brake Pivot Rod	1
8	839C	Brake Pivot Rod Bracket	1
9	836-1	Brake Arm Roller Pin	1
10	835-1	Brake Arm Roller	1
11	844K-1	Brake Arm	1
12	964	Joint Bracket Pin	1
13	956	Brake Joint Bracket	1
14	831B-1	Brake Cushion Adjuster	1
15	1111-1	Spring Collar	2
16	671A-1	Brake Cushion Spring	1
17	961-5	Brake Arm Joint	1
18	825-1	Brake Pivot Rod Collar	2

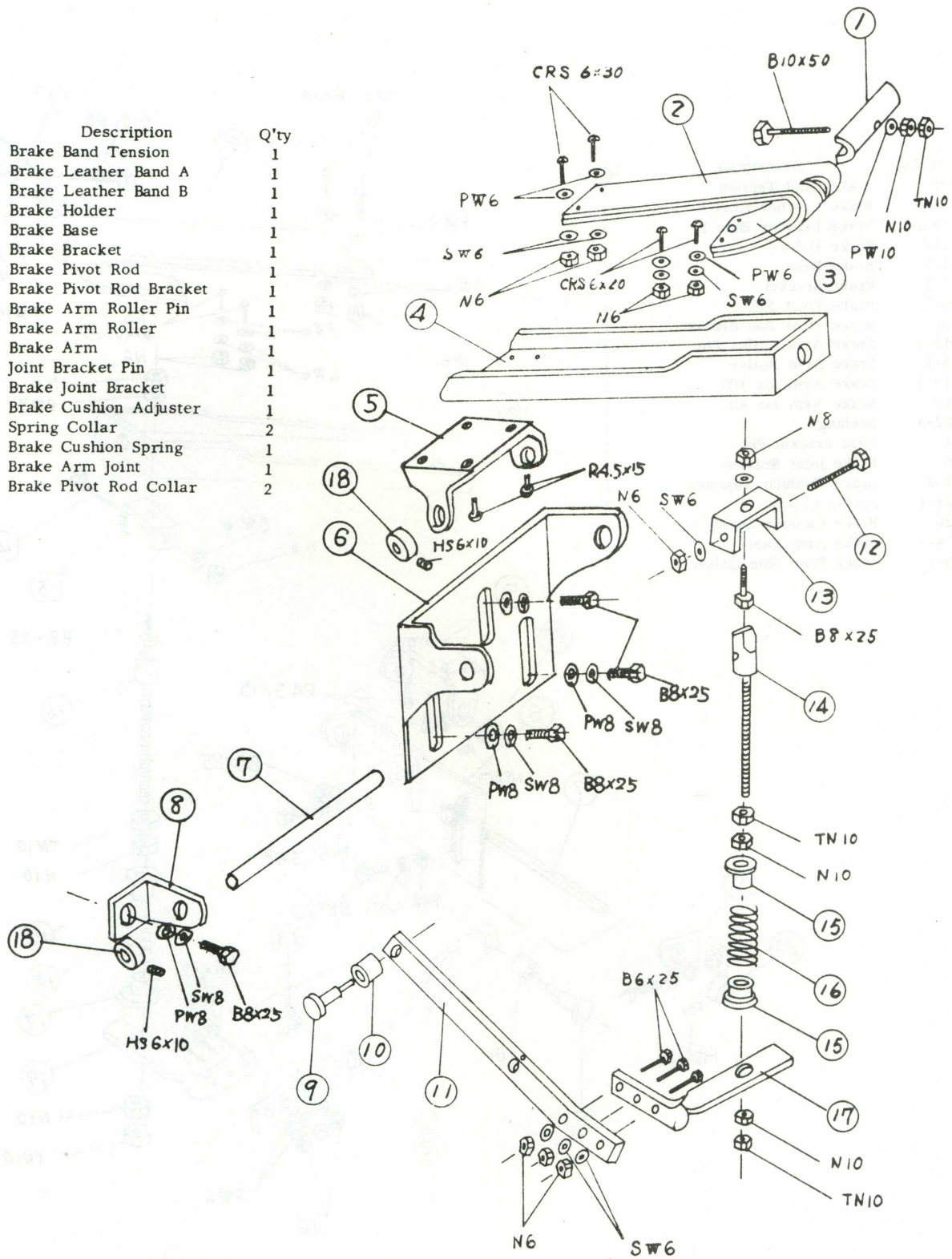

DETAILS OF BRAKE

MODEL 80 & 100

No.	Code No.	Description	Q'ty
1	832K	Brake Band Tention	1
2	1118-3	Brake Leather Band A	1
3	1119-2	Brake Leather Band B	1
4	1117K	Brake Holder	1
5	951-2	Brake Base	1
6	834-1	Brake Bracket	1
7	838-2	Brake Pivot Rod	1
8	839D	Brake Pivot Rod Bracket	1
9	1115-3	Brake Arm Roller Pin	1
10	835-1	Brake Arm Roller	1
11	1110-3	Brake Arm for 100	1
12	8510	Brake Arm for 80	1
13	1122-3	Bushing	1
14	964	Joint Bracket Pin	1
15	956	Brake Joint Bracket	1
16	831-3	Brake Cushion Adjuster	1
17	1111-1	Spring Collar	2
18	1126	Brake Cushion Spring	1
19	1114-3	Brake Arm Joint	1
20	825-1	Brake Pivot Rod Collar	2

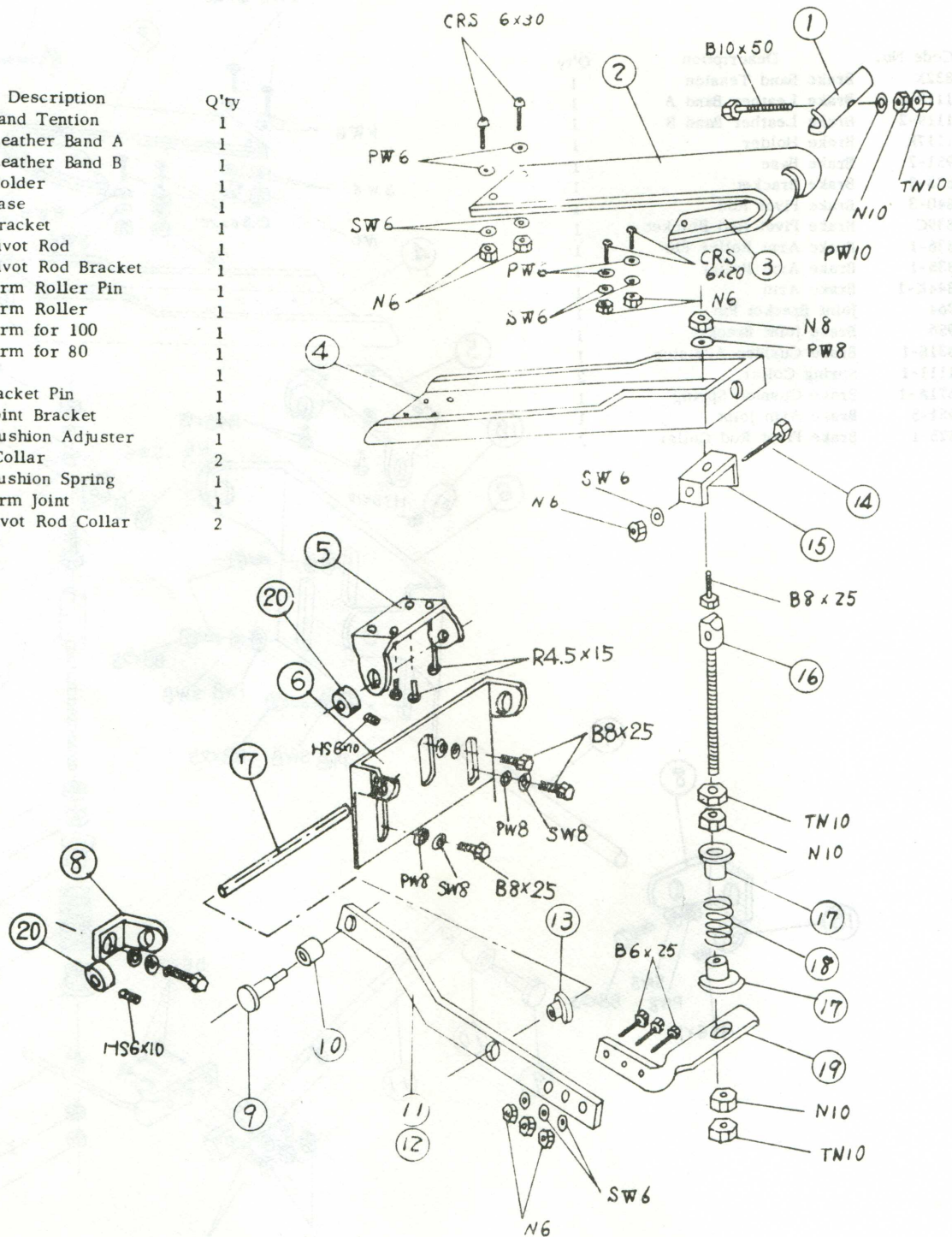

DETAILS OF GUARD & COVER

MODEL 25, 36 & 45

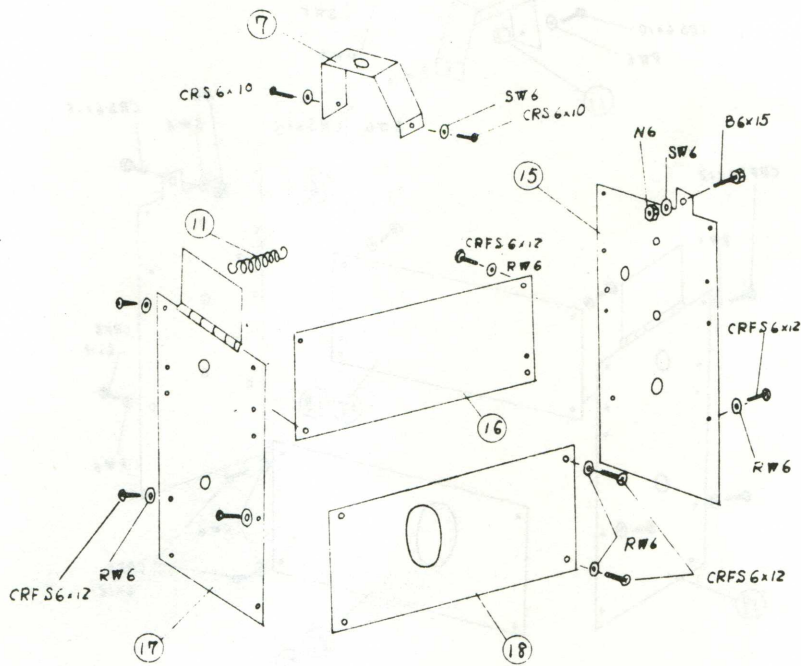
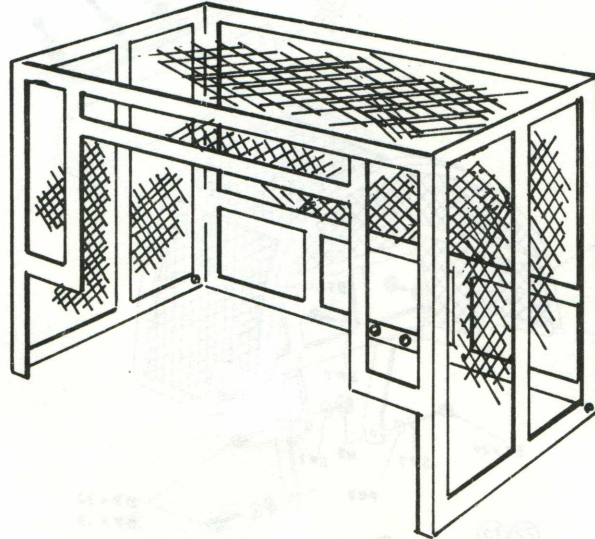

No.	Code No.	Description	Q'ty
7	975L	Chain Cover	1
11	613	Spring	1
15	609L	Rear Cover	1
16	892K-1	Left Side Cover	1
17	608-1	Front Cover	1
18	893K-2	Right Side Cover	1

DETAILS OF GUARD & COVER

MODEL 60

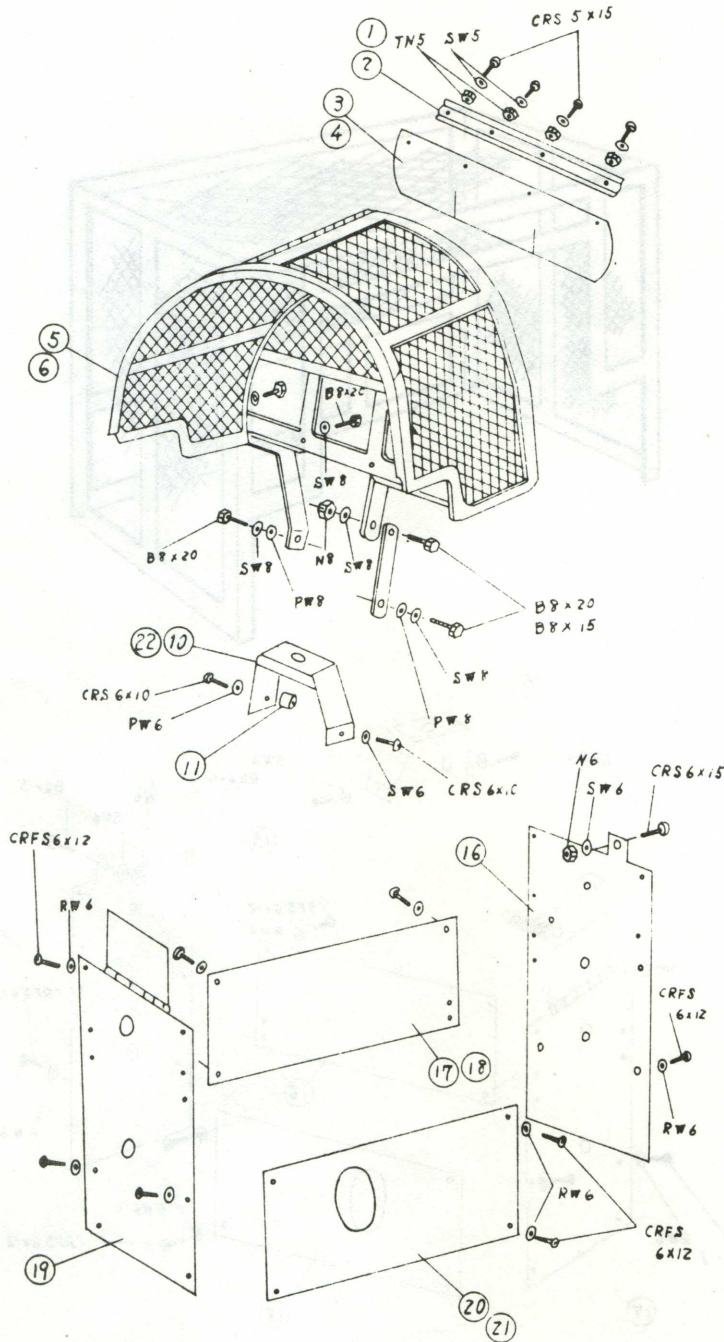

No.	Code No.	Description	Q'ty
1	886	Vinyl Cover Keeper for 45	1
2	888	Vinyl Cover Keeper for 60	1
3	887	Vinyl Cover for 45	1
4	889	Vinyl Cover for 60	1
5	972-8	Upper Guard for 45	1
6	973-7	Upper Guard for 60	1
10	976CK	Chain Cover for 45	1
11	984	Chain Cover Washer	45 --- 60 --- 3
15	613	Spring	1
16	609L	Rear Cover	1
17	611K-3	Left Side Cover	1
19	608-1	Front Cover	1
20	610-1	Right Side Cover	1
22	977L	Chain Cover for 60	1

DETAILS OF UPPER GUARD

MODEL 100

MODEL 80

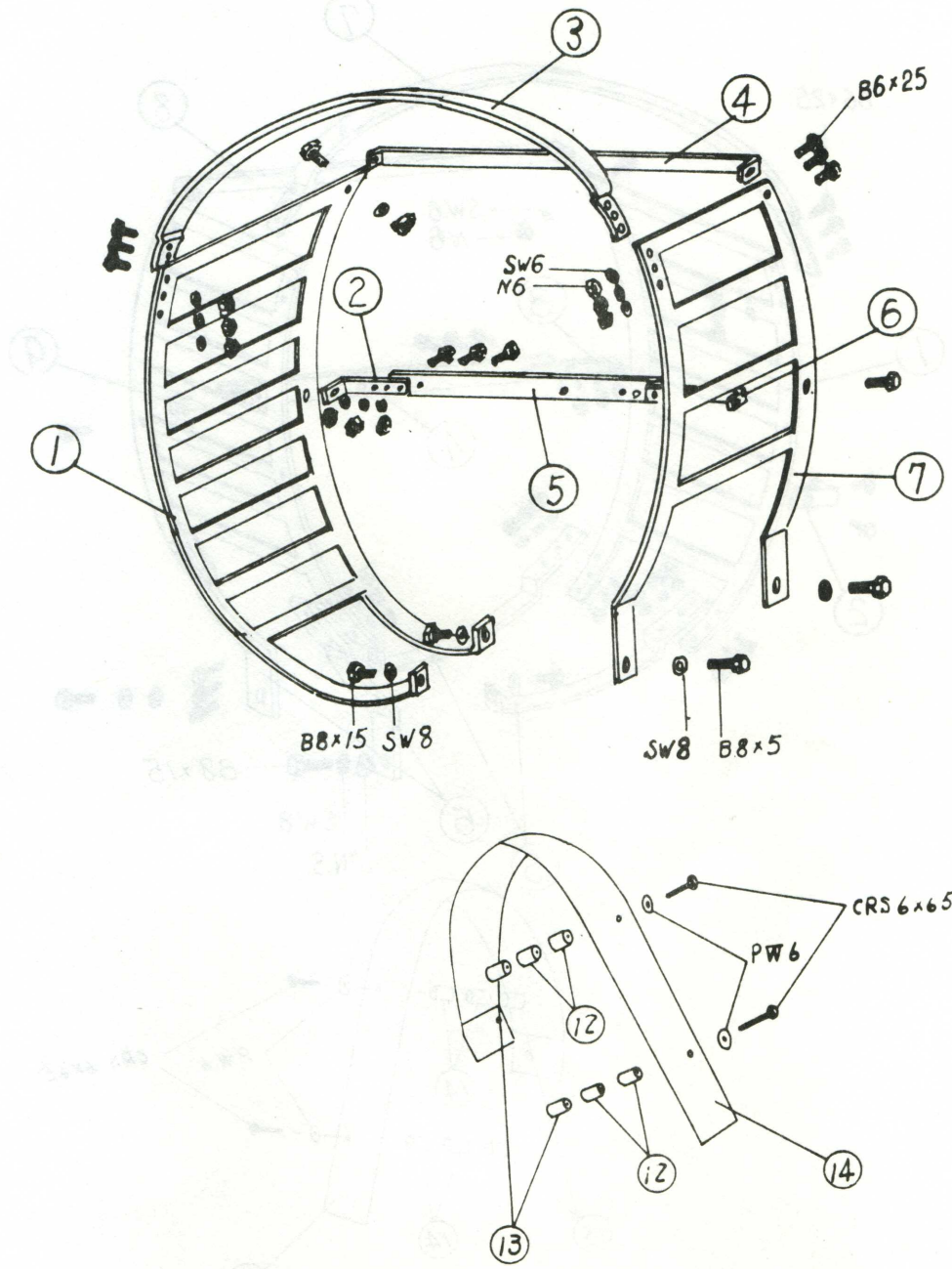

No.	Code No.	Description	Q'ty
1	8516-3	Upper Guard Part	1
2	8525	Upper Guard Part	1
3	8518-2	Upper Guard Part	1
4	8521-1	Upper Guard Part	1
5	8520	Upper Guard Part	1
6	8522	Upper Guard Part	1
7	8517	Upper Guard Part	1
12	984	Chain Cover Washer	4
13	985	Chain Cover Washer	2
14	8512-1	Chain Cover	1

DETAILS OF UPPER GUARD

MODEL 100

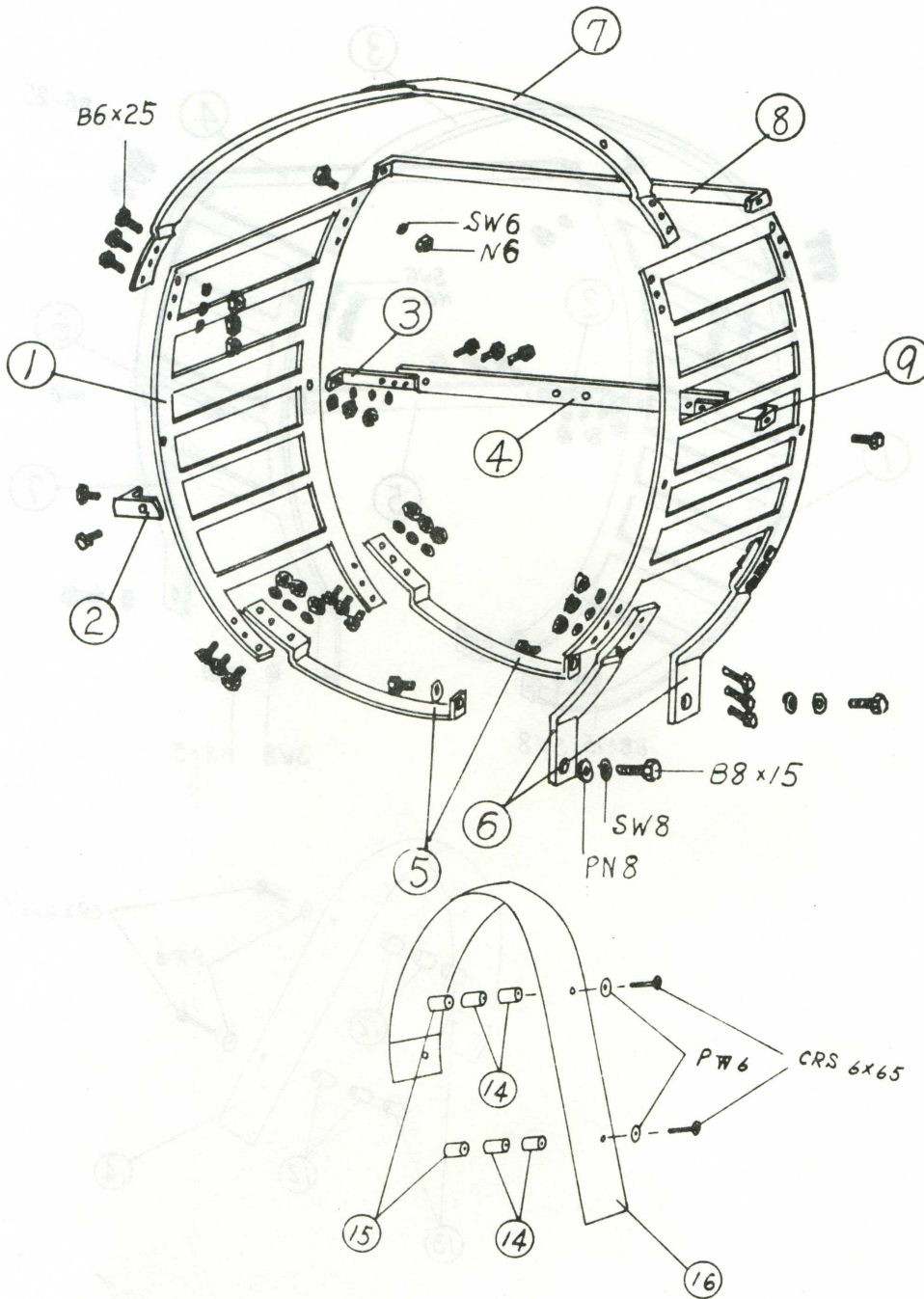

No.	Code No.	Description	Q'ty
1	1082-5	Upper Guard Part	2
2	1092K-2	Upper Guard Part	1
3	1087-1	Upper Guard Part	1
4	1088-1	Upper Guard Part	1
5	1081-5	Upper Guard Part	2
6	1084-6	Upper Guard Part	2
7	1083-7	Upper Guard Part	1
8	1086-1	Upper Guard Part	1
9	1090-1	Upper Guard Part	1
14	984	Chain Cover Washer	4
15	985	Chain Cover Washer	2
16	1100-6	Chain Cover	1

DETAILS OF TABLE

MODEL 25

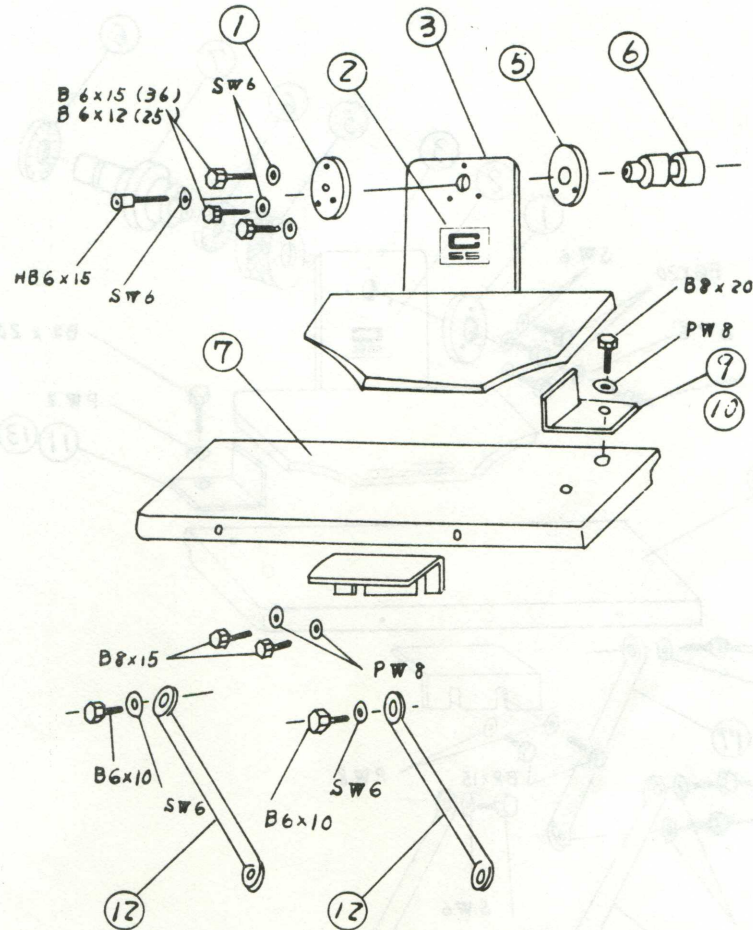

No.	Code No.	Description	Q'ty
1	939-1	Loose Table Pin Plate	1
2	791	Trade Mark Plate	1
3	925K-1	Loose Table	1
5	847	Loose Table Pin Keeper	1
6	846	Loose Table Pin	1
7	978K-2	Main Table	1
9	982-1	Standard at Kontter	1
10	849	Standard at Knotter for Crosswise	1
12	986A	Table Stay	2

DETAILS OF TABLE

MODELS 36 & 45

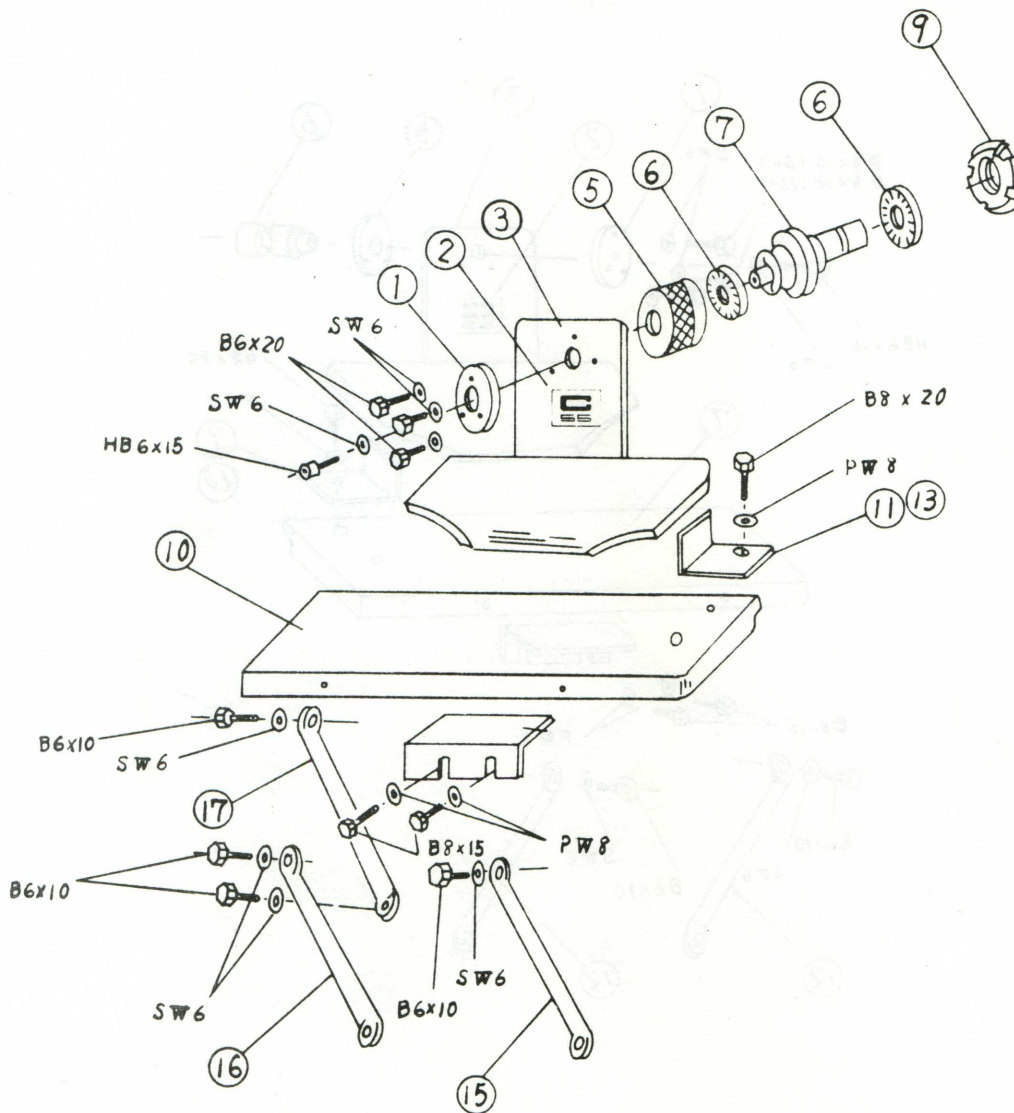

No.	Code No.	Description	Q'ty
1	939-1	Loose Table Pin Plate	1
2	791	Trade Mark Plate	1
3	927K-1	Loose Table	1
5	936-1	Loose Table Pin Keeper	1
6		Thrust Needle Bearing AX3553	2
7	938-1	Loose Table Pin	1
9	937	Lock Nut	1
10	980K	Main Table	1
11	982-1	Standard at Knotter	1
13	894	Standard at Knotter for Crosswise	1
15	987A	Table Stay	1
16	987B	Table Stay	1
17	987C	Table Stay	1

When ordering parts, please specify Part No. and Model Number 36 or 45.

DETAILS OF TABLE

MODEL 60

No.	Code No.	Description	Q'ty
1	939-1	Loose Table Pin Plate	1
2	791	Trade Mark Plate	1
3	928K-1	Loose Table	1
4	936-1	Loose Table Pin Keeper	1
5		Thrust Needle Bearing AX3553	2
6	937	Lock Nut	1
7	998K-1	Upper Guard Stay	1
8	938-1	Loose Table Pin	1
10	981K-2	Main Table	1
11	997-2	Standard at Knotter	1
14	965	Table Stay	2
15	965C	Table Stay	1
16	965D	Table Stay	1
17	965E	Table Stay	1

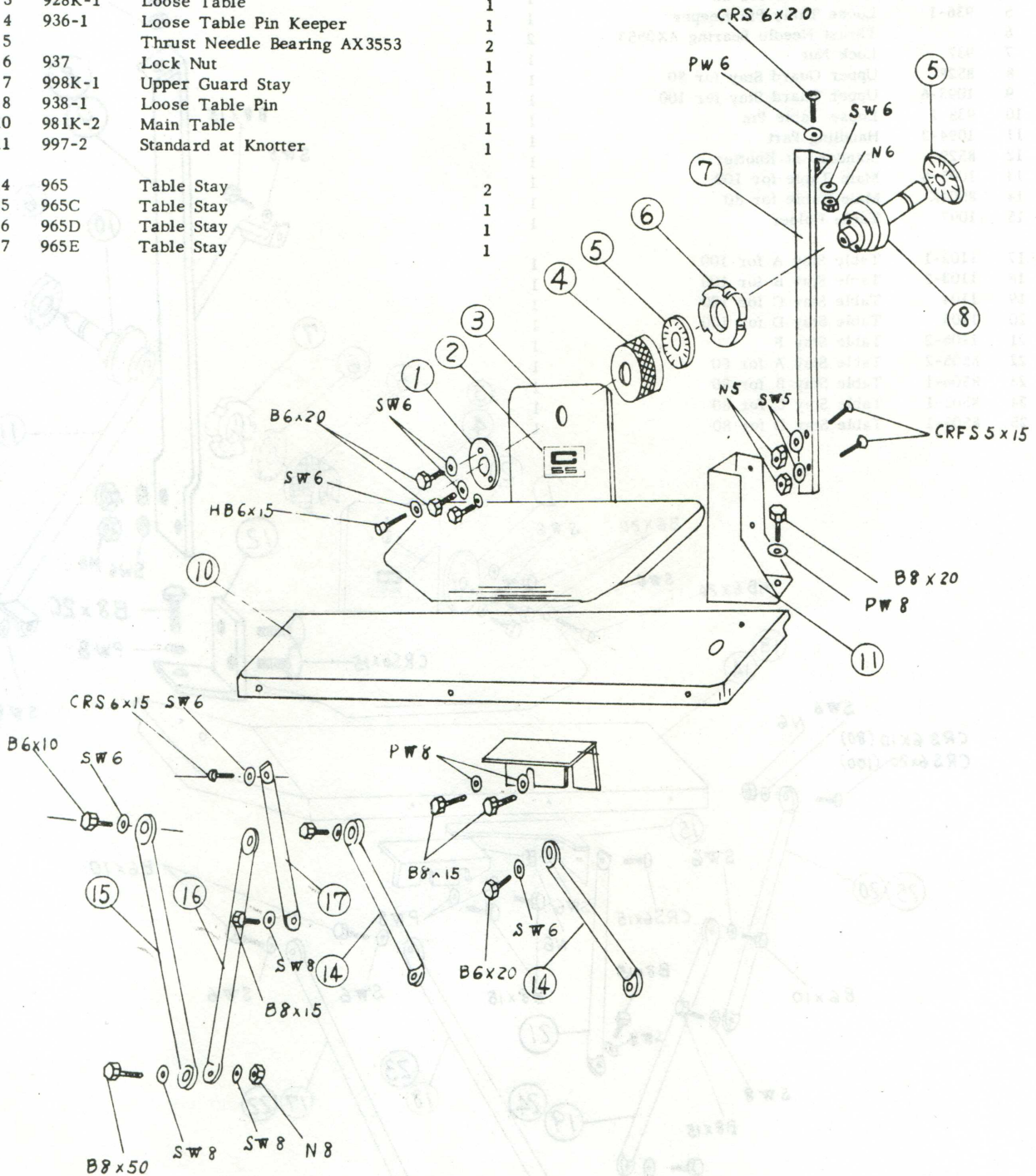

DETAILS OF TABLE

MODEL 80 & 100

No.	Code No.	Description	Q'ty
1	939-1	Loose Table Pin Plate	1
2	791	Trade Mark Plate	1
3	1076K-1	Loose Table for 100	1
4	8503-4	Loose Table for 80	1
5	936-1	Loose Table Pin Keeper	1
6		Thrust Needle Bearing AX3553	2
7	937	Lock Nut	1
8	8528	Upper Guard Stay for 80	1
9	1093-6	Upper Guard Stay for 100	1
10	938-1	Loose Table Pin	1
11	1094-2	Handling Part	1
12	8529	Standard at Knotter	1
13	1095-6	Main Table for 100	1
14	8504K	Main Table for 80	1
15	1097	Table Holder	1
17	1102-1	Table Stay A for 100	1
18	1103-2	Table Stay B for 100	1
19	1104	Table Stay C for 100	1
20	1105	Table Stay D for 100	1
21	1106-2	Table Stay E	1
22	8505-2	Table Stay A for 80	1
23	8506-1	Table Stay B for 80	1
24	8508-1	Table Stay C for 80	1
25	8509-1	Table Stay D for 80	1

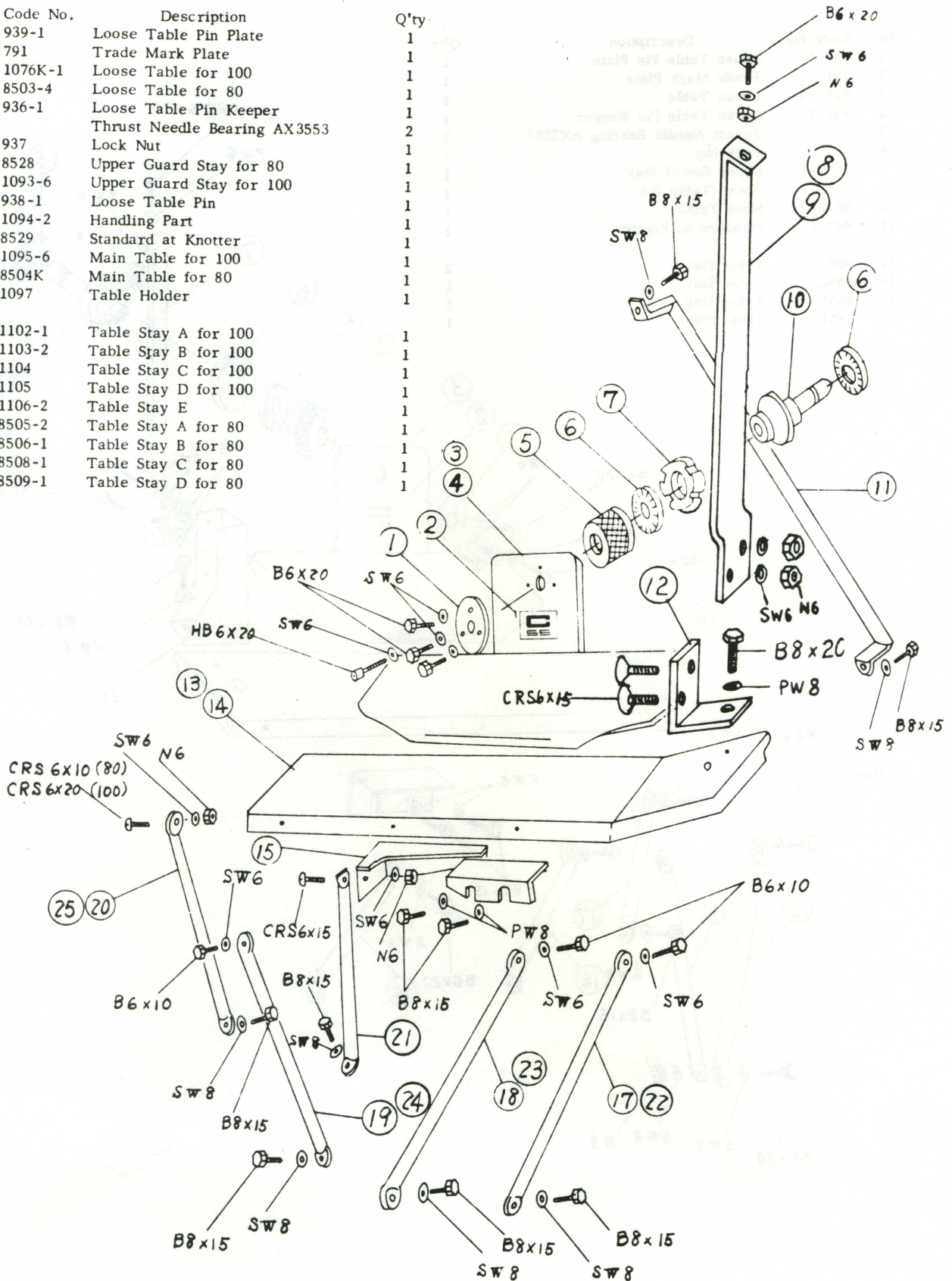

DETAILS OF STEP DOWN PULLEY

MODEL 80 & 100 Triple wrap 50 & 60Hz

100 Double wrap 60Hz

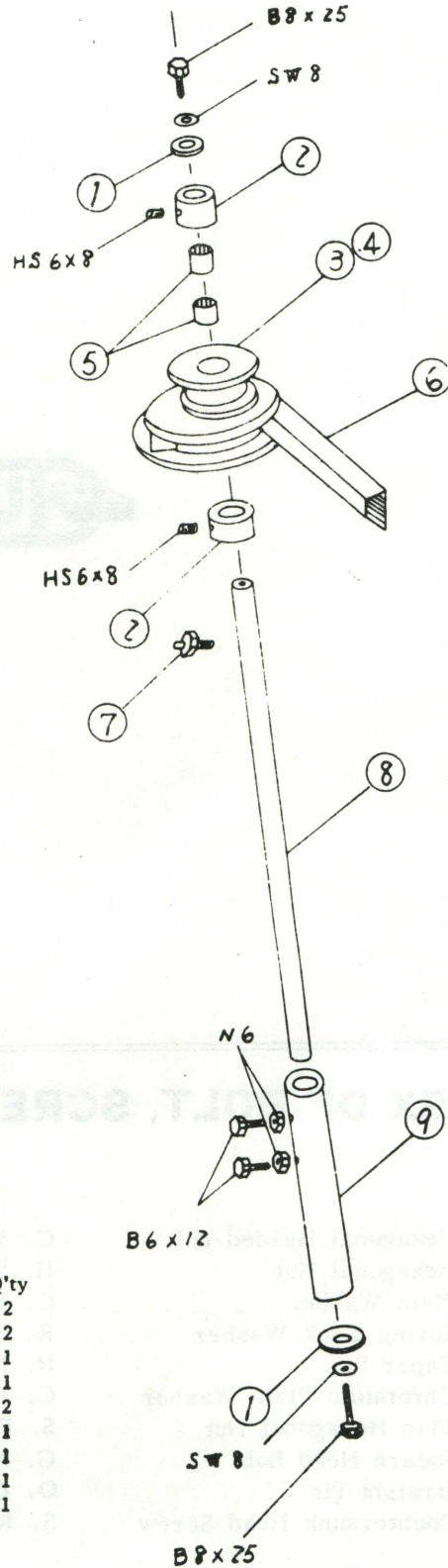

No.	Code No.	Description	Q'ty
1	1163-1	Washer	2
2	651	Pulley Collar	2
3	1053-3	Step Down Pulley for Triple Warp 50Hz	1
4	1054-3	Step Down Pulley for Triple Wrap 60Hz	1
5		Needle Roller Bearing SC1412	2
6		V-Belt A-29	1
7		Grease Nipple 6M	1
8	1055-1	Step Down Pulley Shaft	1
9	1056-1	Joint Shaft	1



INDEX OF BOLT, SCREW, NUT, WASHER & PIN

B	Hexagonal Headed Bolt	C. F. S	Cross-Recessed Flat Head Screw
N	Hexagonal Nut	H. S	Hexagonal Socket Headless Screw
P. W	Plain Washer	C. R. F. S	Cross-Recessed Countersunk Head Screw
S. W	Spring Lock Washer	R. S	Recessed Head Machine Screw
T. P	Taper Pin	H. B	Hexagonal Socket Head Screw
C. P. W	Chromium Plain Washer	C. B. W	Toothed Lock Washer
T. N	Thin Hexagonal Nut	S. P	Spring Pin
S. B	Square Head Bolt	G. N	Grease Nipple
P	Straight Pin	O. C	Oil Cap
F. S	Countersunk Head Screw	S. R	Snap Ring